



**RECORD OF TITLE
UNDER LAND TRANSFER ACT 2017
FREEHOLD
Search Copy**



R. W. Muir
Registrar-General
of Land

Identifier **CB20F/1226**
Land Registration District **Canterbury**
Date Issued 14 November 1979

Prior References
CB559/47

Estate Fee Simple
Area 892 square metres more or less
Legal Description Lot 3 Deposited Plan 18886

Registered Owners
Housing New Zealand Limited

Interests
Subject to Part IV A Conservation Act 1987
Subject to Section 11 Crown Minerals Act 1991

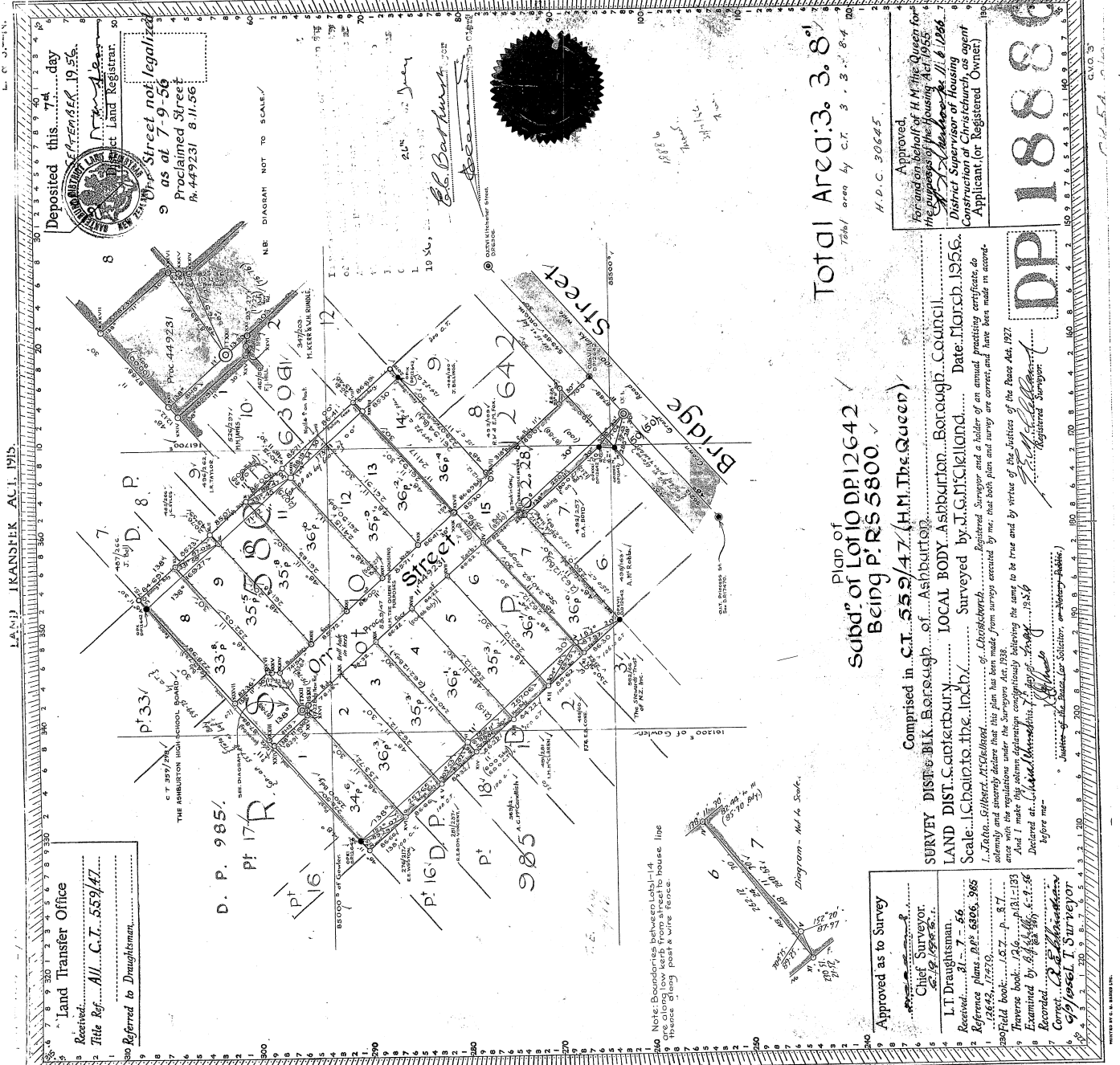

Deposited this 7th day
of February 1956.
 By [Signature]
 District Land Registrar.

Street not legalized
 as at 7-9-56
 Proclaimed Street
 No. 449231 8.11.56

N.B. DIAGRAM NOT TO SCALE!

[Signature]
 District Land Registrar

Total Area: 3.3.8
 Total area by C.T. 3.3.8-4

Approved
 for and on behalf of H.M. The Queen for
 the purposes of the Housing Act 1955
[Signature]
 District Supervisor of Housing
 Construction of Christchurch, as agent
 Applicant (or Registered Owner)

DP 188886

Plan of
 Subdⁿ of Lot 10 DP 12642
 Being P. R. S. 800

Comprised in C.T. 559/47 (H.M. The Queen)
 SURVEY DIST. BLK. Boroough of Ashburton
 LAND DIST. Canterbury LOCAL BODY Ashburton Borough Council
 Scale: 1 inch to the foot. Surveyed by J.G.M. Giggilland Date: March 1956.
 I, [Signature], Licensed Surveyor, and a holder of an annual practicing certificate do
 solemnly and sincerely swear under the Surveyors Act 1938
 that I make this solemn declaration conscientiously believing the same to be true and by virtue of the Oath Act 1927
 Declared at Christchurch this 7th day of February 1956
[Signature]
 Registered Surveyor

Approved as to Survey
 Chief Surveyor
 Received: 21-7-56
 L.T. Draughtsman
 Reference Plans: P.P. 6306, 985
 12642, 17759
 200 Field book: 152, p. 87
 Inverse book: 126, p. 51, 133
 Examined by: [Signature], 4.1.56
 Corrected by: [Signature]
 Corrected by: [Signature]

Note: Boundaries between fields
 are shown by dashed lines to house line
 these being post & wire fence.

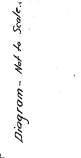

Land Transfer Office
 Received:
 Title Ref. All... C.T. 559/47
 Referred to Draughtsman