



NOTES:

• The source of the data and an estimate of its accuracy are stated below. Fox & Associates Ltd does not guarantee any data sourced from a third party. If the use of third party data is critical to the project then it should be independently verified.

PROPERTY DATA:

• Boundaries and dimensions shown herein may be subject to legal definition survey.
• The boundary data has been sourced from several different surveys of different ages. The accuracy of the data is estimated to be approximately +/- 50mm.

SPATIAL DATA:

• The physical data has been captured using survey equipment to an accuracy of approximately +/- 30mm (horizontal).

DATE OF SURVEY:

• Field survey carried out on 26 September 2023

COORDINATE SYSTEM:

• Coordinates are in terms of Gawler 2000
• Reference Mark: IS IV DP 23186, 770°17.88mN, 425825.61mE

AERIAL PHOTOGRAPHY

• The aerial imagery is orthophotography provided by Environment Canterbury. Data sourced from canterburymaps.govt.nz "Latest Imagery" layer on 27 September 2023 and is used under Creative Commons 3.0 license.

TITLE REFERENCE:

• CB3D/465

CERTIFICATION:

I, Alex Liggett, hereby certify that this survey has been carried out by me, or under my direction, to the accuracies as set out above.

Alex Liggett
Licensed Cadastral Surveyor

KEY:

TR Tree

Symbols and Linework:

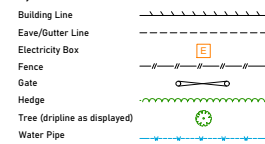

Approved District Planning
 Consent Documents
 LUC23/0033
 Sheet 1 of 2
 Ashburton District Council

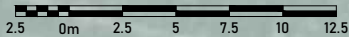

Site Plan
798 Longbeach Rd
1:250 at A4

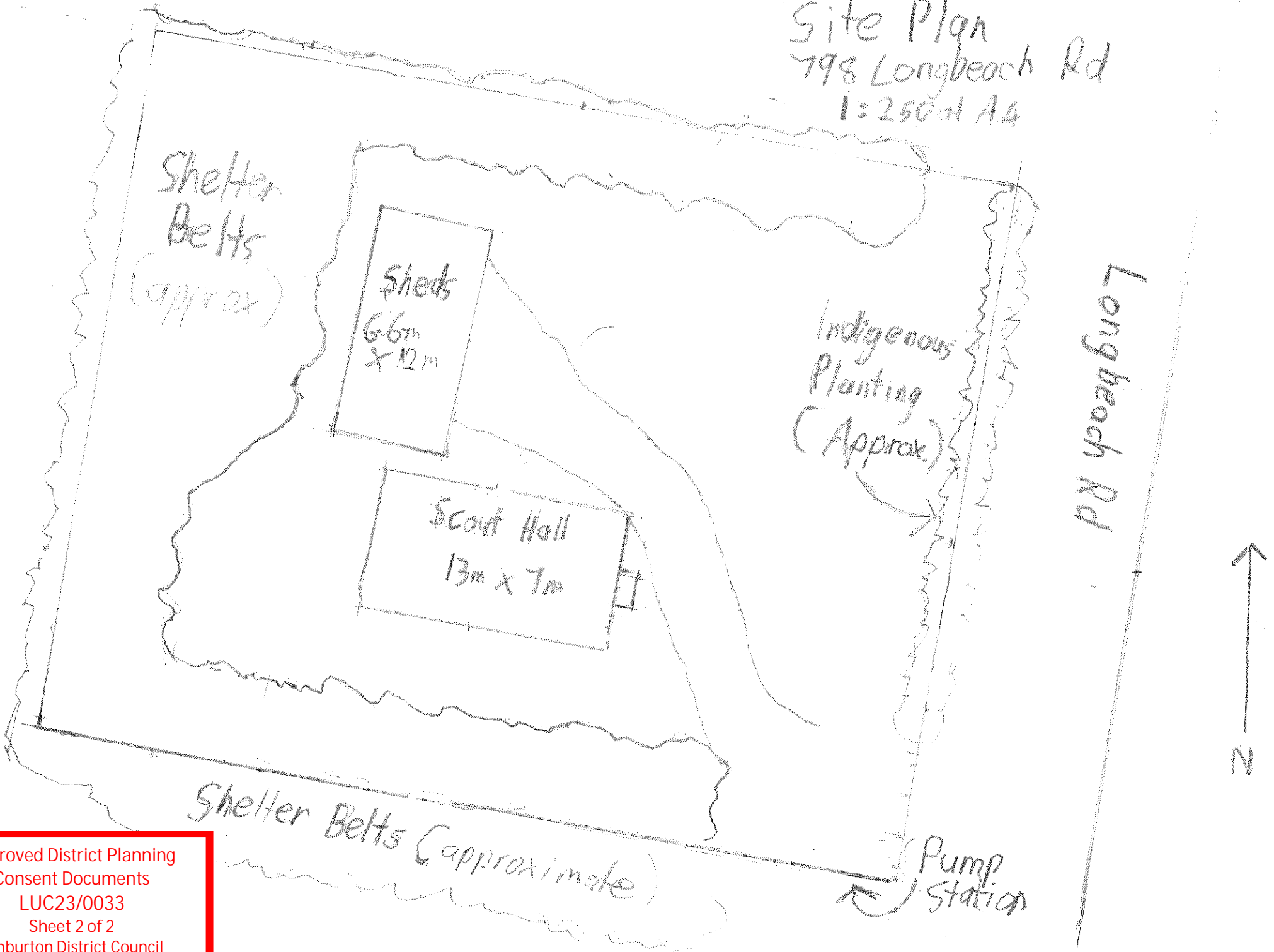

Approved District Planning
Consent Documents
LUC23/0033
Sheet 2 of 2
Ashburton District Council