

MOUNTABLE ISLAND KERB

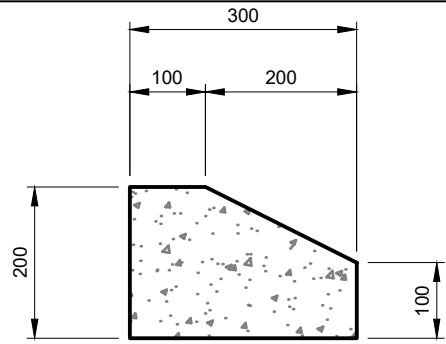

MOUNTABLE NIB KERB
AS PER NZS 4404:2010

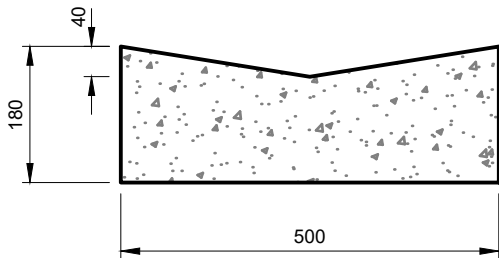

STANDARD DISH CHANNEL

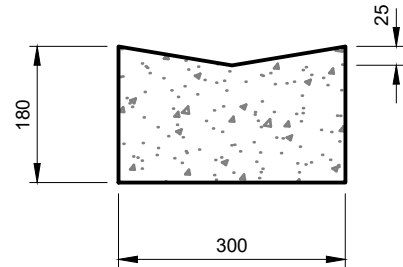

DISH CHANNEL 300 WIDE

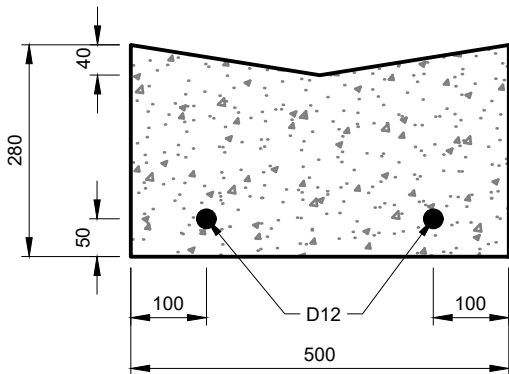

REINFORCED DISH CHANNEL

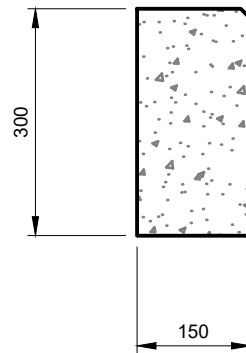

STANDARD NIB KERB
AS PER NZS 4404:2010

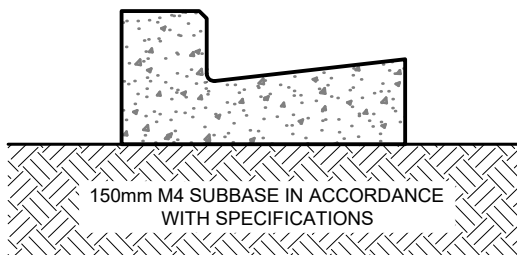

FOUNDATION DETAIL

NOTES:

1. CONCRETE TO BE NZS 3109 WITH A 28 DAY STRENGTH - 30mPa
2. A BASECOURSE LAYER UNDER THE K&C AND APRON MUST BE 150mm AP40 M/4 COMPACTED TO TNZ B/2
3. SCALA TEST THE SUBGRADE SURFACE TO ACHIEVE A CBR OF 7 MINIMUM
4. SHOULD THE SUBBASE MATERIAL BE UNSUITABLE A 150mm MINIMUM DEPTH OF AP65 MUST BE LAID AND COMPACTED TO A MAXIMUM DEPTH OF 1m BELOW THE FINISHED LEVEL OF THE CROSSING

DRAWING USED

BY TLA :

ADC Y/N TDC Y/N

MDC Y/N WDC Y/N

NO.	REVISION	BY	CHK	APP	DATE
C	LAYOUT UPDATE				05/20
B	ISSUED FOR CONSTRUCTION				11/15
A	ISSUED FOR MAINTENANCE CONTRACT				07/15

TITLE:

KERB & CHANNEL PROFILES

AORAKI ROADING COLLABORATION

ORIGINAL SCALE (A4):

NTS

DRAWING NUMBER:

G-101

REVISION:

C

SHEET:

2

OF:

2

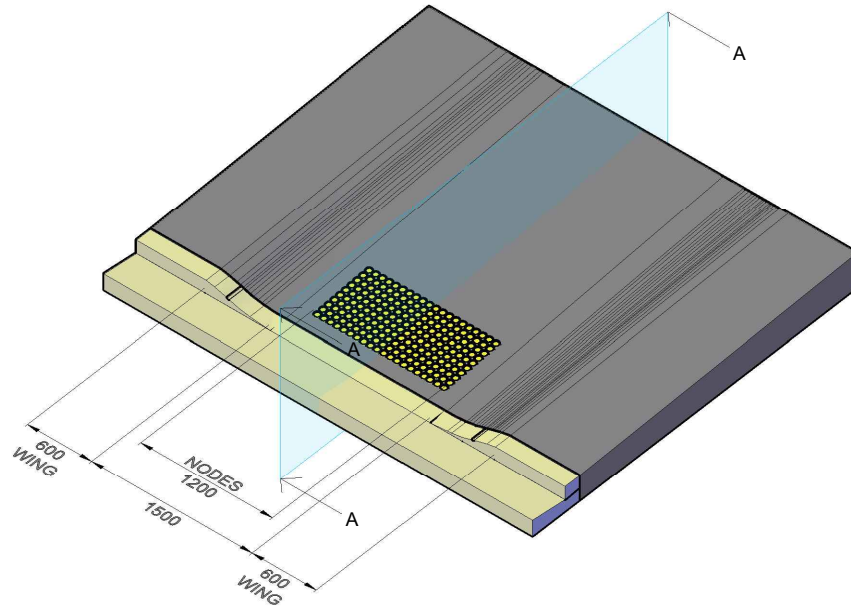

MID BLOCK DROP KERB CROSSING

NOT TO SCALE

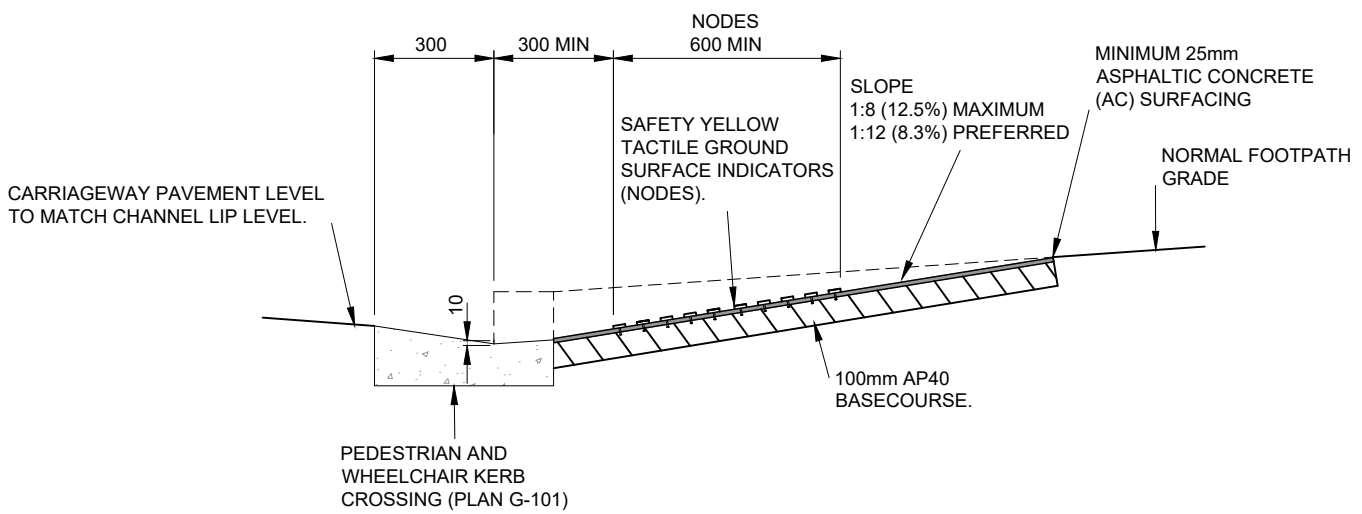

CROSS SECTION A-A

DRAWING USED BY TLA :	ADC Y/N	TDC Y/N			TITLE: FOOTPATH MID BLOCK DROP KERB CROSSING AORAKI ROADING COLLABORATION	ORIGINAL SCALE (A4):	NOT TO SCALE	REVISION: G-102 C	
	MDC Y/N	WDC Y/N				DRAWING NUMBER:			
						2			OF: 4

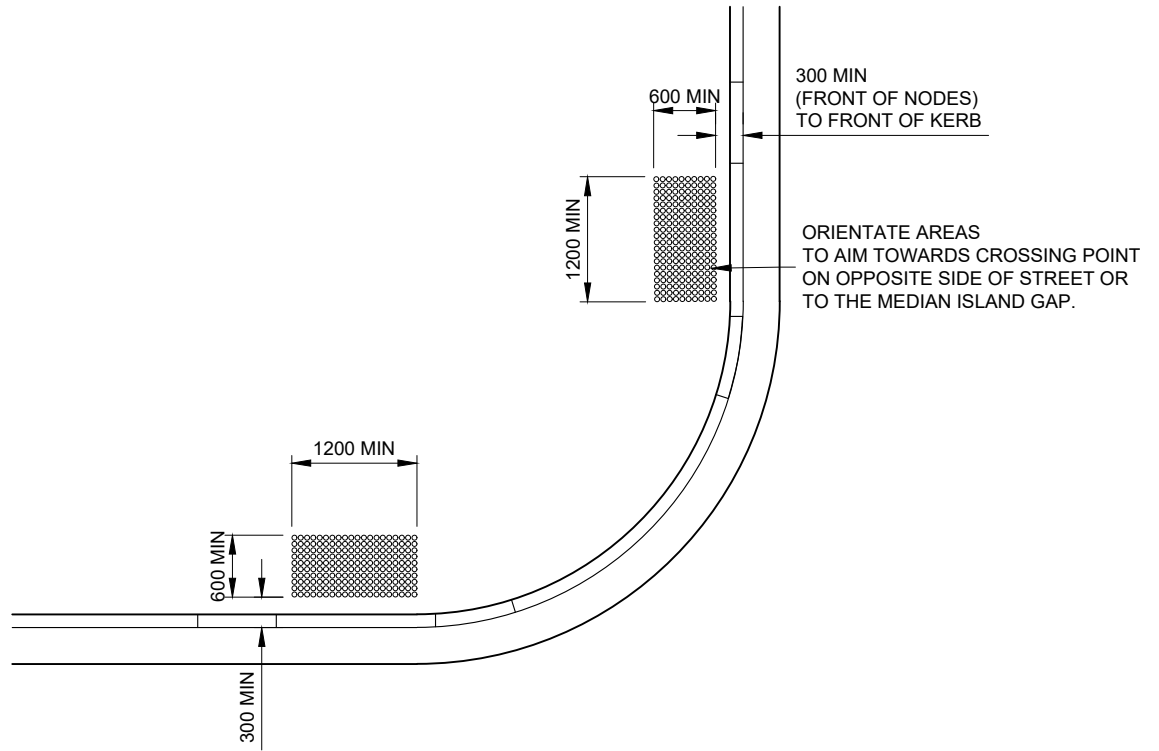

PREFERRED TYPE

ORIENTATE AREAS TO AIM TOWARDS CROSSING POINT ON OPPOSITE SIDE OF STREET OR TO THE MEDIAN ISLAND GAP.

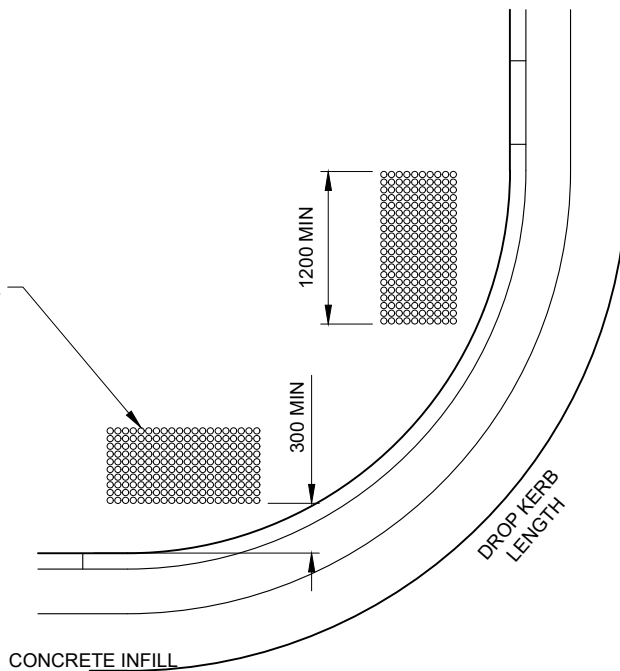

ALTERNATIVE TYPE

(IF PREFERRED TYPE CANNOT BE CONSTRUCTED).

DRAWING USED BY TLA :
 ADC Y/N TDC Y/N
 MDC Y/N WDC Y/N

No.	REVISION	BY	CHK	APP.	DATE
C	TITLE BLOCK UPDATE	MAT	SD		04/20
B	ISSUED FOR CONSTRUCTION	MAT	GRP	SWD	11/15
A	ISSUED FOR MAINTENANCE CONTRACT	MAT	GRP	SWD	07/15

TITLE:

**FOOTPATH
 MINIMUM WIDTHS**
 AORAKI ROADING COLLABORATION

ORIGINAL SCALE (A4): NOT TO SCALE

DRAWING NUMBER:

G-102

REVISION:

C

SHEET: 3 OF 4

KERB & CHANNEL

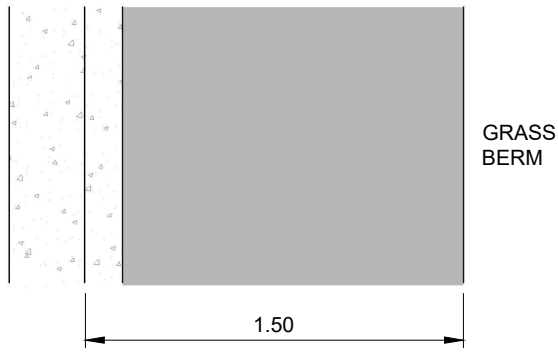

FACE OF KERB

POWER POLE OR STREET LIGHT POLE

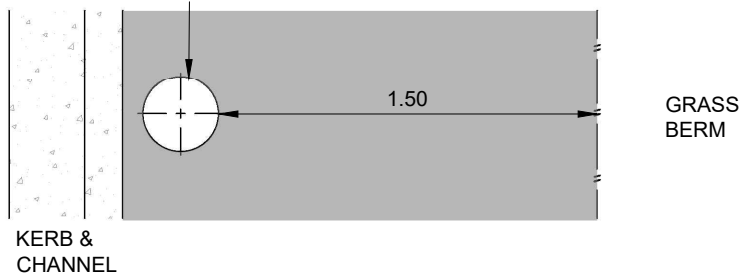

GRASS BERM

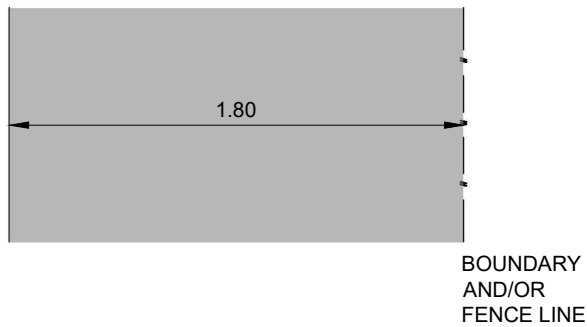

KERB & CHANNEL

BOUNDARY AND/OR FENCE LINE

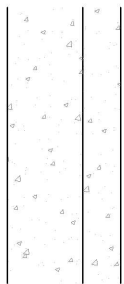

GRASS BERM

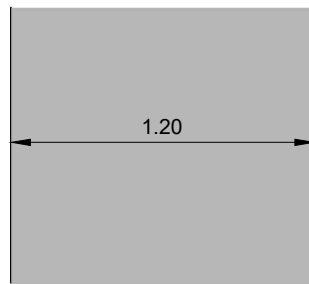

GRASS BERM

DRAWING USED
BY TLA :
ADC Y/N TDC Y/N
MDC Y/N WDC Y/N

NO.	REVISION	BY	CHK	APP.	DATE
A	NEW DRAWING				4/20

TITLE:

**FOOTPATH
MINIMUM WIDTHS**
AORAKI ROADING COLLABORATION

ORIGINAL SCALE (A4): NOT TO SCALE

DRAWING NUMBER:

G-102

REVISION:

A

SHEET: 4 OF 4

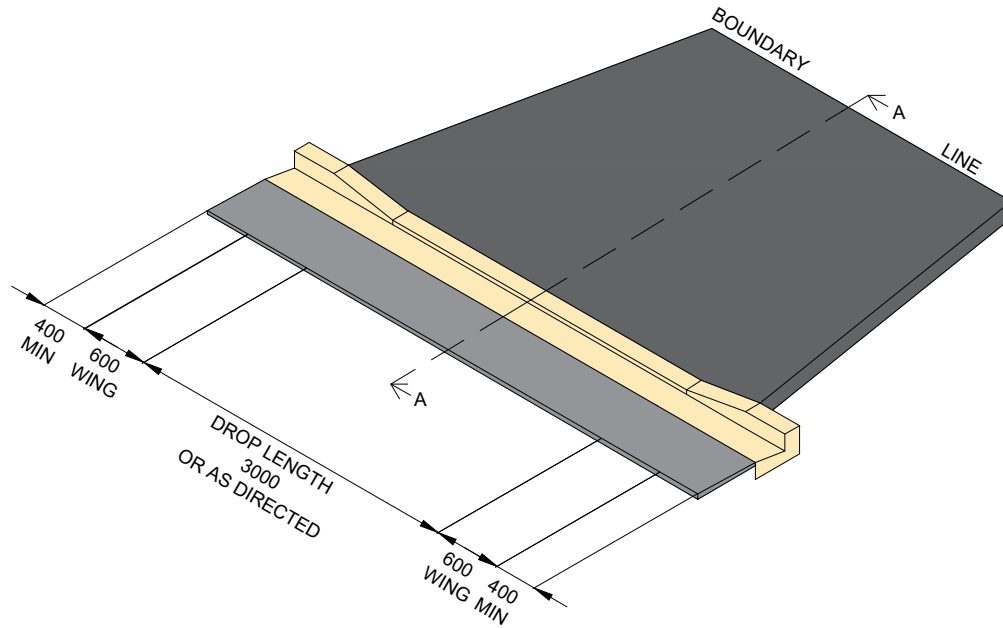

VEHICLE KERB CROSSING - STANDARD DROP
NOT TO SCALE

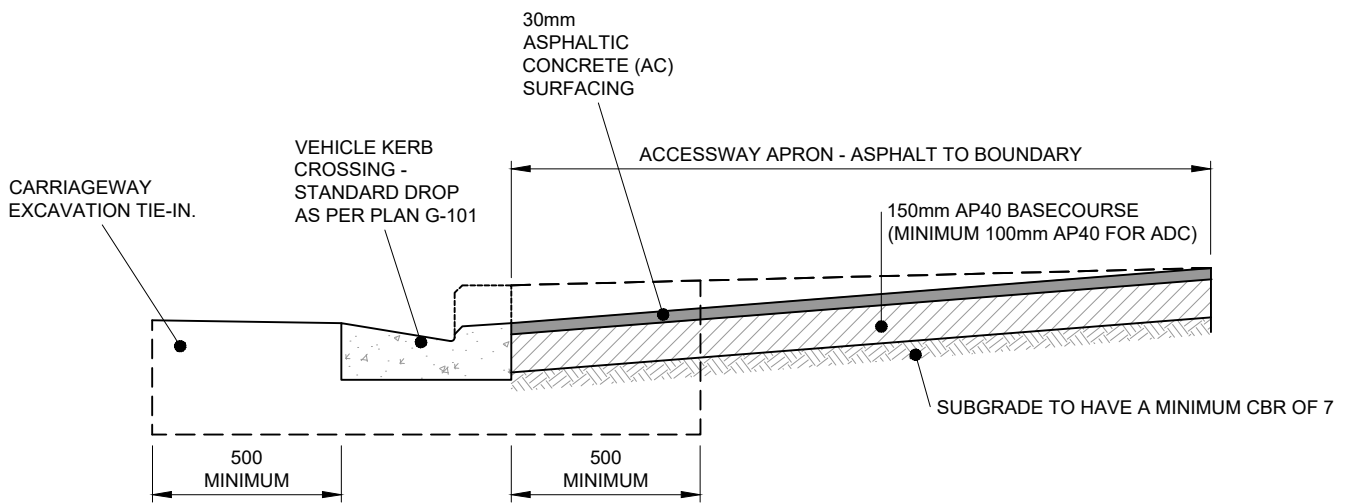

CROSS SECTION A-A
NOT TO SCALE

DRAWING USED BY TLA :	ADC Y/N	TDC Y/N					TITLE: VEHICLE KERB CROSSING - STANDARD DROP AORAKI ROADING COLLABORATION	ORIGINAL SCALE (A4):	NTS		
	MDC Y/N	WDC Y/N						DRAWING NUMBER:	G-103		
								REVISION:	C		
								SHEET:	1 OF 1		
	C	DETAILING UPDATE	MAT	SD	AD	05/20					
	B	ISSUED FOR CONSTRUCTION	MAT	GRP	SWD	11/15					
	A	ISSUED FOR MAINTENANCE CONTRACT	MAT	GRP	SWD	7/15					
	No.	REVISION	BY	CHK	APP.	DATE					

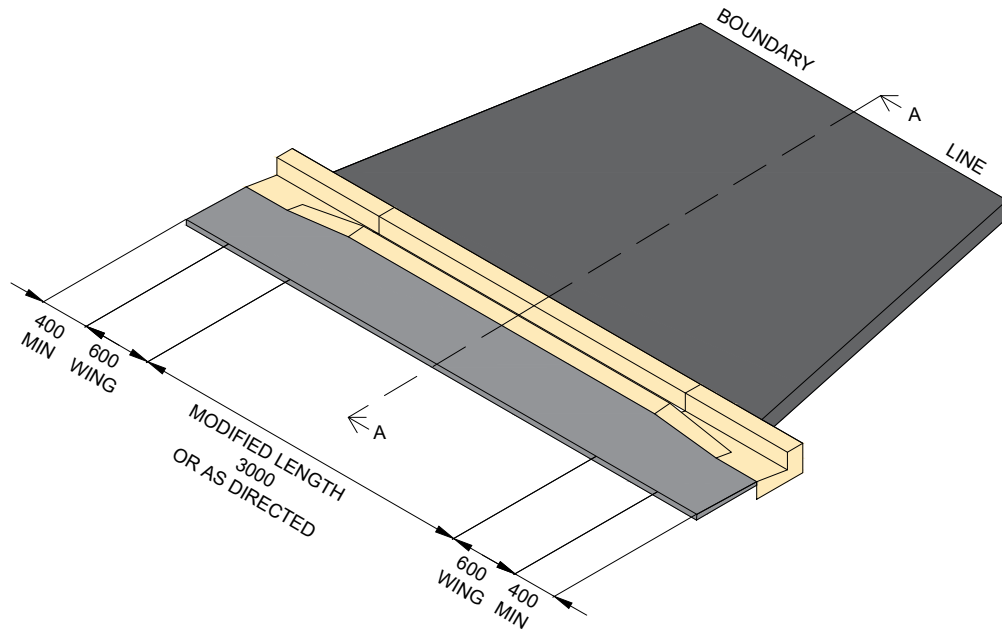

VEHICLE KERB CROSSING - STANDARD MODIFIED
NOT TO SCALE

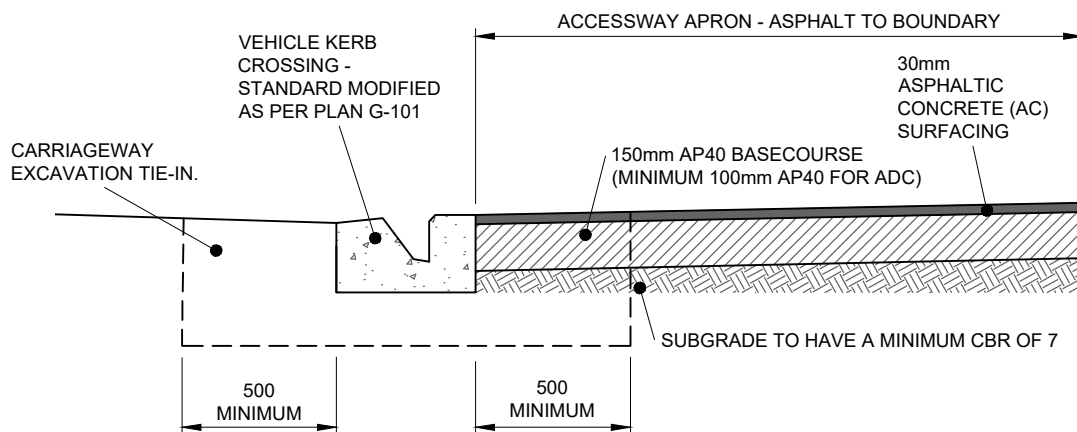

CROSS SECTION A-A
NOT TO SCALE

DRAWING USED BY TLA :										TITLE: VEHICLE KERB CROSSING - STANDARD MODIFIED AORAKI ROADING COLLABORATION	ORIGINAL SCALE (A4):	NTS	
	ADC Y/N	TDC Y/N									DRAWING NUMBER:	G-104	REVISION:
	MDC Y/N	WDC Y/N										A	
											SHEET:	1	OF 1

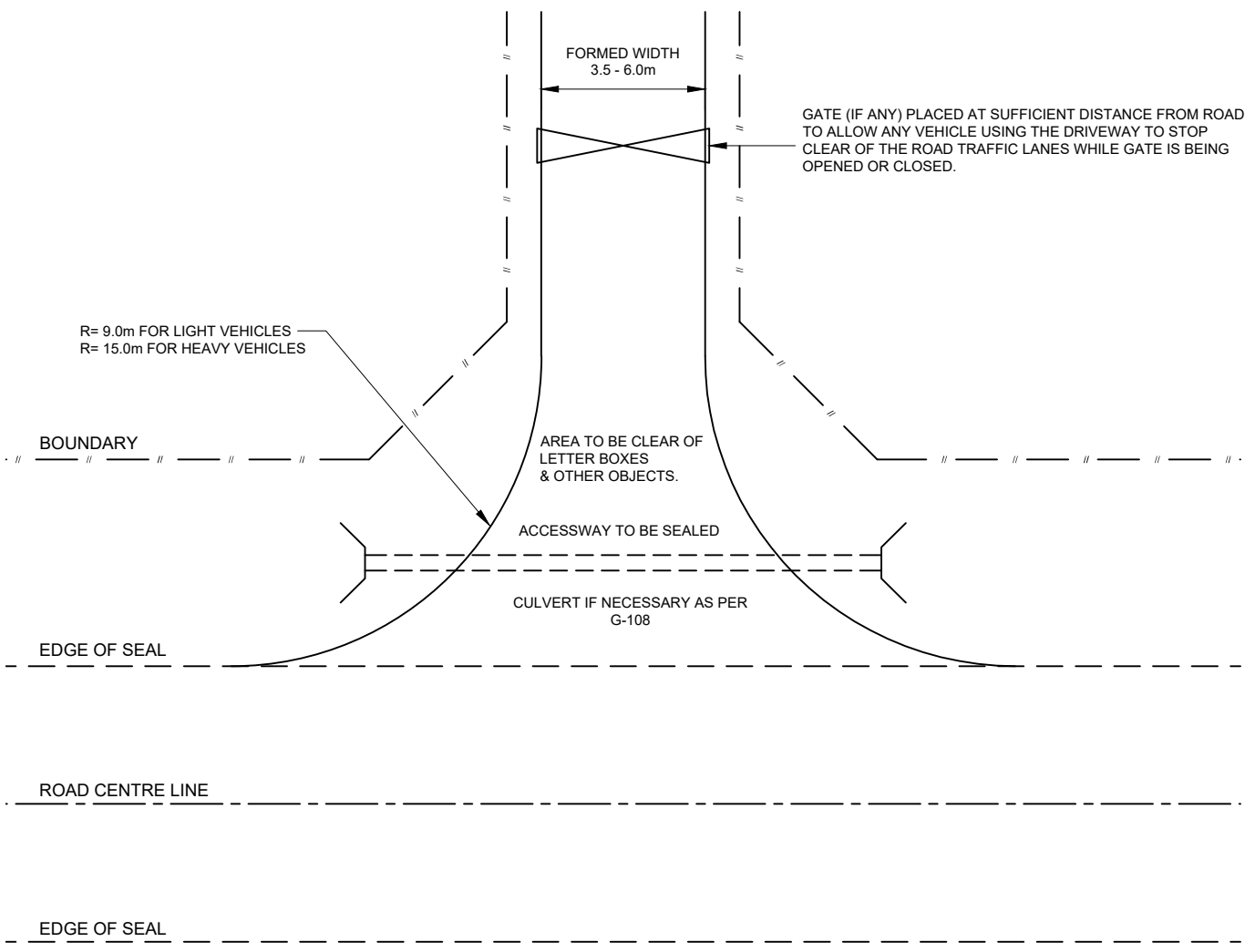

DRAWING USED BY TLA :									
ADC Y/N TDC Y/N									
MDC Y/N WDC Y/N									
No.	REVISION	BY	CHK	APP.	DATE				
A	NEW DRAWING				05/20				

TITLE: **RURAL ENTRANCEWAYS**
COLLECTOR & LOCAL ACCESS ROADS
 AORAKI ROADING COLLABORATION

ORIGINAL SCALE (A4):	NTS
DRAWING NUMBER:	G-105
REVISION:	A
SHEET:	1 OF 1

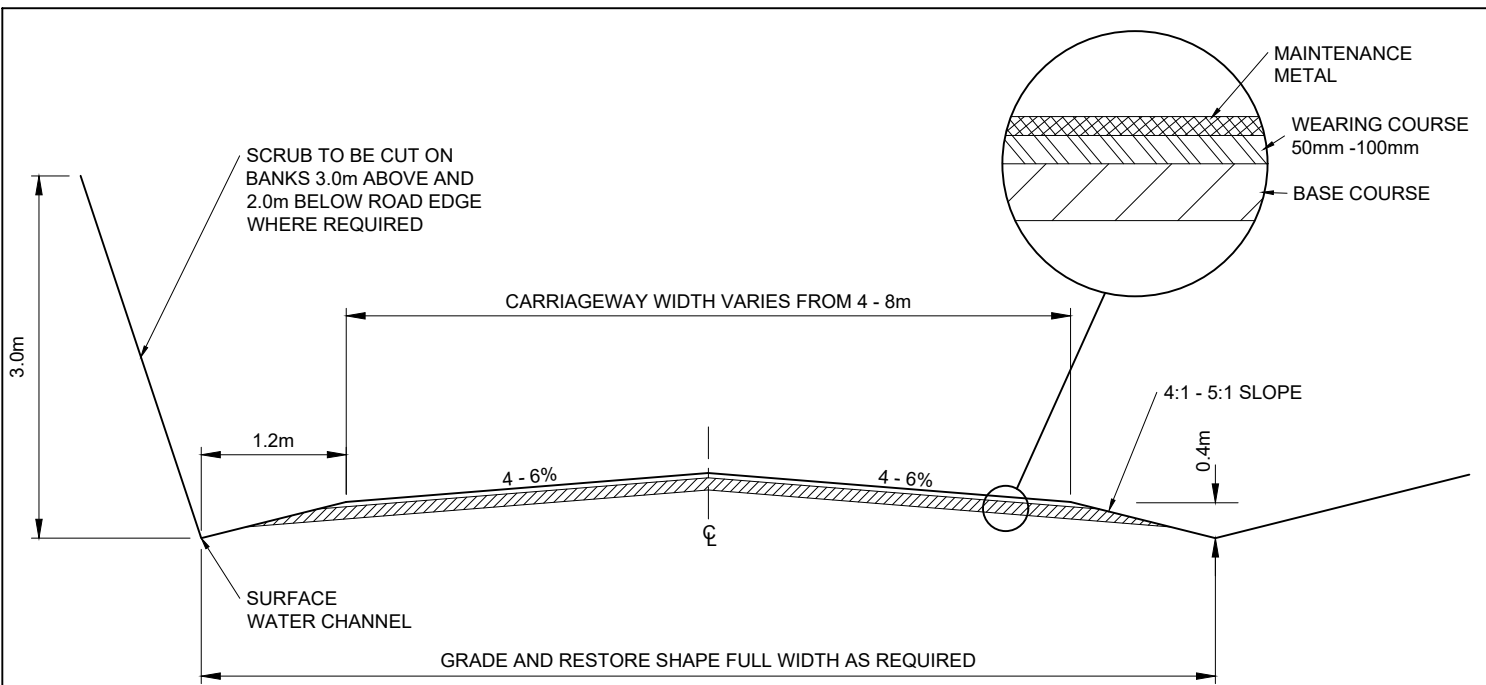

STANDARD CROSS SECTION - UNSEALED RURAL ROAD
NOT TO SCALE

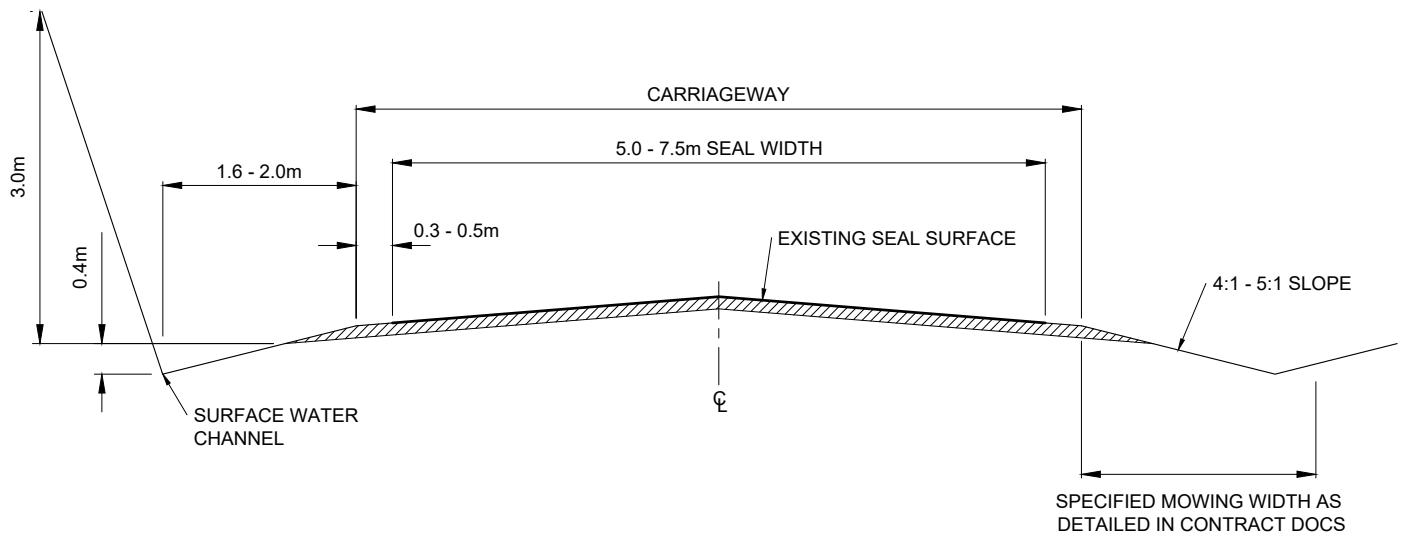

STANDARD CROSS SECTION - SEALED RURAL ROAD
NOT TO SCALE

DRAWING USED BY TLA :									TITLE:	ORIGINAL SCALE (A4):	NOT TO SCALE	
	ADC Y/N	TDC Y/N							SEAL & UNSEALED RURAL ROADS AORAKI ROADING COLLABORATION	DRAWING NUMBER:	G-106	
	MDC Y/N	WDC Y/N						REVISION:		C		
									SHEET:	1	OF:	2

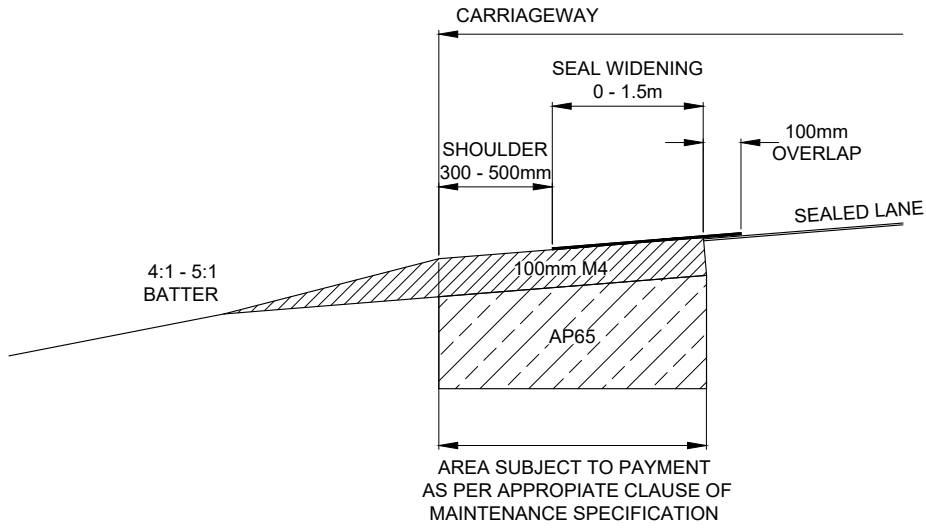

STANDARD CROSS SECTION - SEAL WIDENING
NOT TO SCALE

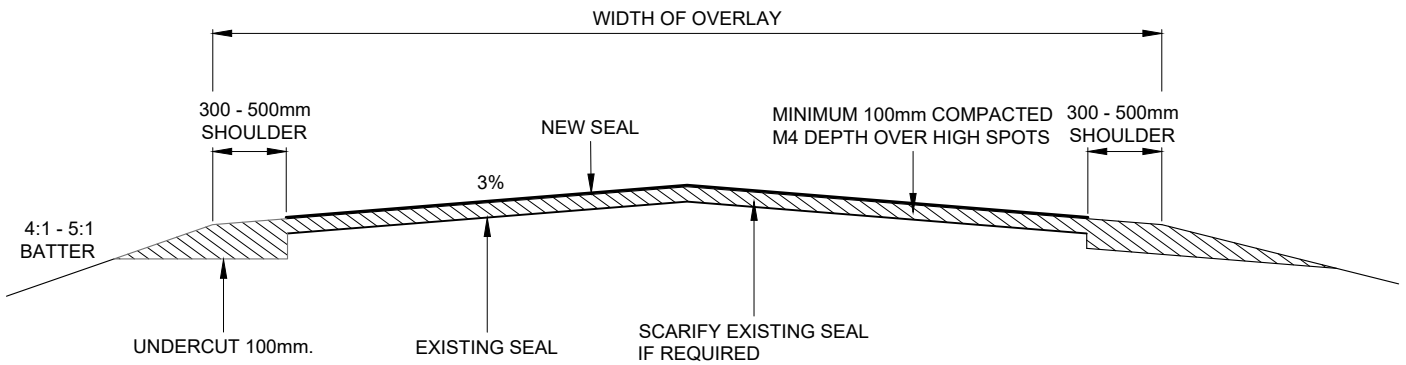

STANDARD CROSS SECTION - SEAL OVERLAY
NOT TO SCALE

DRAWING USED BY TLA : ADC Y/N TDC Y/N MDC Y/N WDC Y/N	<table border="1" style="width: 100%; border-collapse: collapse;"> <tr> <td style="width: 5%;">C</td> <td style="width: 45%;">TITLE BLOCK UPDATE</td> <td style="width: 5%;">WHC</td> <td style="width: 5%;">PH</td> <td style="width: 10%;">SWD</td> <td style="width: 10%;">05/20</td> </tr> <tr> <td>B</td> <td>Issued for Construction</td> <td>MAT</td> <td>GRP</td> <td>SWD</td> <td>11/15</td> </tr> <tr> <td>A</td> <td>Issued for Combined Maintenance Contract</td> <td>MAT</td> <td>GRP</td> <td>SWD</td> <td>7/15</td> </tr> <tr> <td>No.</td> <td>REVISION</td> <td>BY</td> <td>CHK</td> <td>APP.</td> <td>DATE</td> </tr> </table>	C	TITLE BLOCK UPDATE	WHC	PH	SWD	05/20	B	Issued for Construction	MAT	GRP	SWD	11/15	A	Issued for Combined Maintenance Contract	MAT	GRP	SWD	7/15	No.	REVISION	BY	CHK	APP.	DATE	TITLE: SEAL WIDENING & SEAL OVERLAY AORAKI ROADING COLLABORATION	ORIGINAL SCALE (A4): NOT TO SCALE DRAWING NUMBER: G-106 SHEET: 2 OF 2	REVISION: C
C	TITLE BLOCK UPDATE	WHC	PH	SWD	05/20																							
B	Issued for Construction	MAT	GRP	SWD	11/15																							
A	Issued for Combined Maintenance Contract	MAT	GRP	SWD	7/15																							
No.	REVISION	BY	CHK	APP.	DATE																							

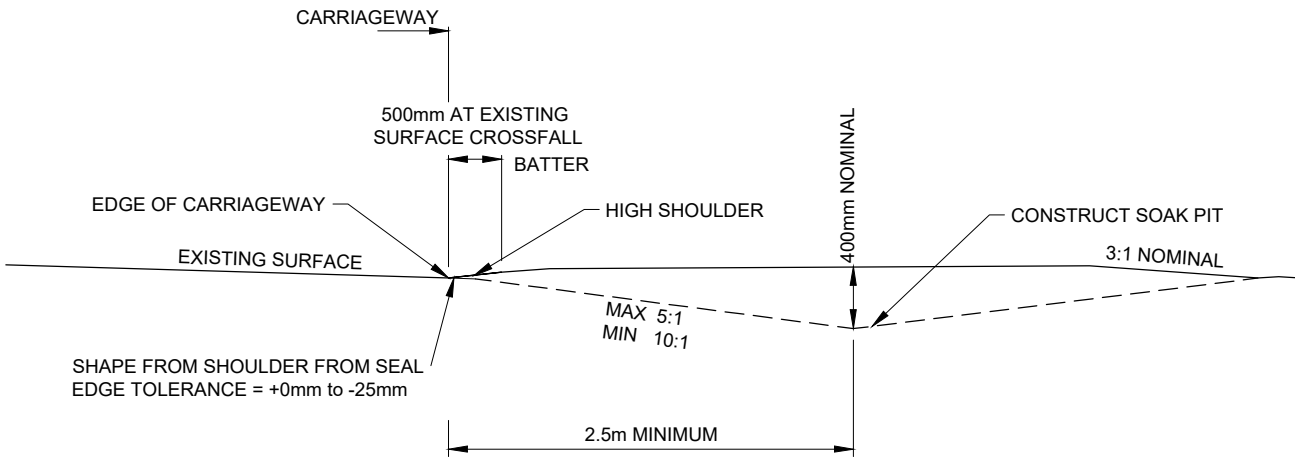

TYPE 3
SURFACE CHANNEL CONSTRUCTION

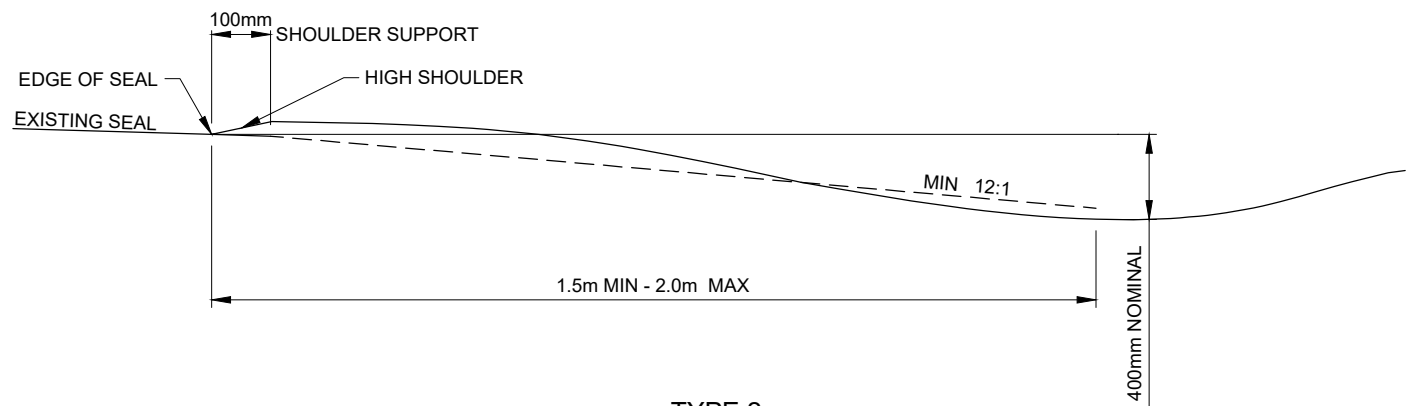

TYPE 2
SURFACE CHANNEL CLEANING

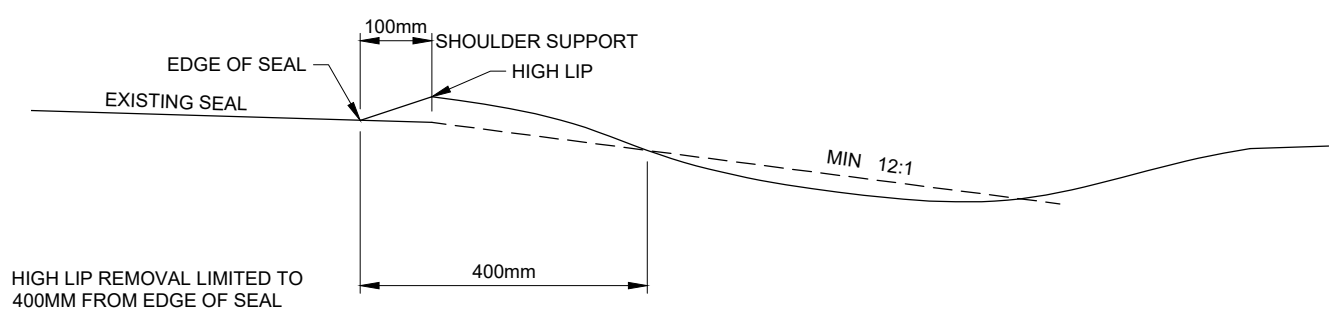

TYPE 1
HIGH LIP REMOVAL

DRAWING USED BY TLA : ADC Y/N TDC Y/N MDC Y/N WDC Y/N	SURFACE CHANNELS & HIGH LIP REMOVAL AORAKI ROADING COLLABORATION	ORIGINAL SCALE (A4): NOT TO SCALE DRAWING NUMBER: <div style="font-size: 2em; font-weight: bold; text-align: center;">G-107</div> SHEET 1 OF 1	REVISION: <table border="1" style="width:100%; border-collapse: collapse; margin-top: 10px;"> <tr> <td style="width:5%;">No.</td> <td style="width:45%;">REVISION</td> <td style="width:10%;">BY</td> <td style="width:10%;">CHK</td> <td style="width:10%;">APP</td> <td style="width:10%;">DATE</td> </tr> <tr> <td>C</td> <td>TITLE BLOCK UPDATED</td> <td>MAT</td> <td>SD</td> <td>AD</td> <td>05/20</td> </tr> <tr> <td>B</td> <td>ISSUED FOR CONSTRUCTION</td> <td>MAT</td> <td>GRP</td> <td>SWD</td> <td>11/15</td> </tr> <tr> <td>A</td> <td>ISSUED FOR MAINTENANCE CONTRACT</td> <td>MAT</td> <td>GRP</td> <td>SWD</td> <td>7/15</td> </tr> </table>	No.	REVISION	BY	CHK	APP	DATE	C	TITLE BLOCK UPDATED	MAT	SD	AD	05/20	B	ISSUED FOR CONSTRUCTION	MAT	GRP	SWD	11/15	A	ISSUED FOR MAINTENANCE CONTRACT	MAT	GRP	SWD	7/15
No.	REVISION	BY	CHK	APP	DATE																						
C	TITLE BLOCK UPDATED	MAT	SD	AD	05/20																						
B	ISSUED FOR CONSTRUCTION	MAT	GRP	SWD	11/15																						
A	ISSUED FOR MAINTENANCE CONTRACT	MAT	GRP	SWD	7/15																						

Original Sheet Size A4 (210 x 297) N:\Standard Plans\G Series\dwg\Rev C\G-107 Swale Drain Detail Rev C.dwg DO NOT SCALE - IF IN DOUBT ASK

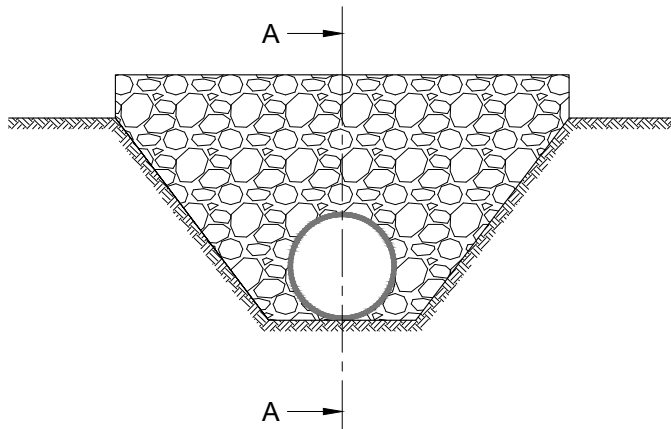

COBBLED HEADWALL DETAIL

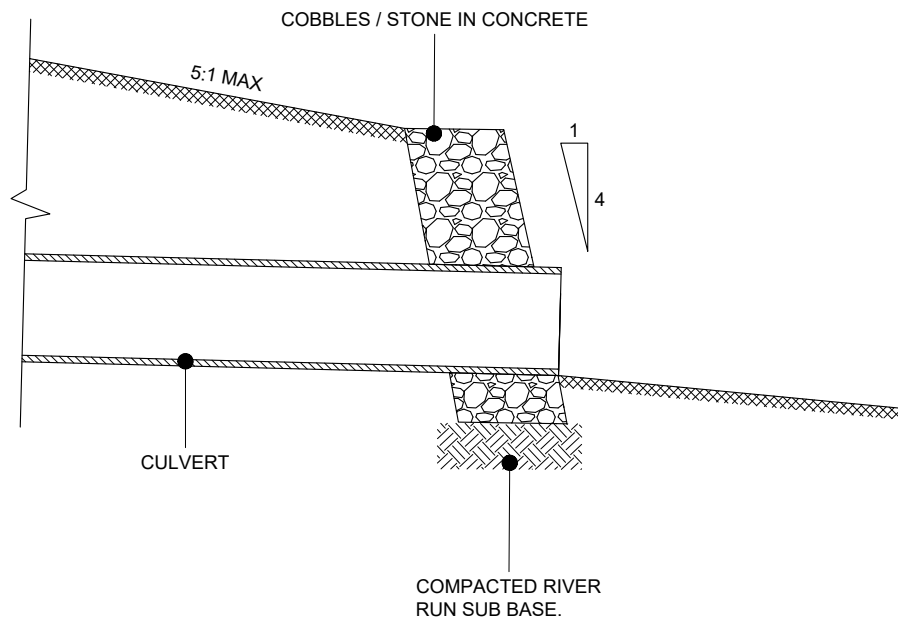

SECTION A-A

DRAWING USED
BY TLA :
ADC Y/N TDC Y/N
MDC Y/N WDC Y/N

No.	REVISION	BY	CHK	APP.	DATE
C	TEXT UPDATES				05/20
B	ISSUED FOR CONSTRUCTION				11/15
A	ISSUED FOR MAINTENANCE CONTRACT				07/15

TITLE:

**RURAL CULVERT
COBBLED HEADWALL**
AORAKI ROADING COLLABORATION

ORIGINAL SCALE (A4): NOT TO SCALE

DRAWING NUMBER:

G-108

REVISION:

C

SHEET: 1 OF 2

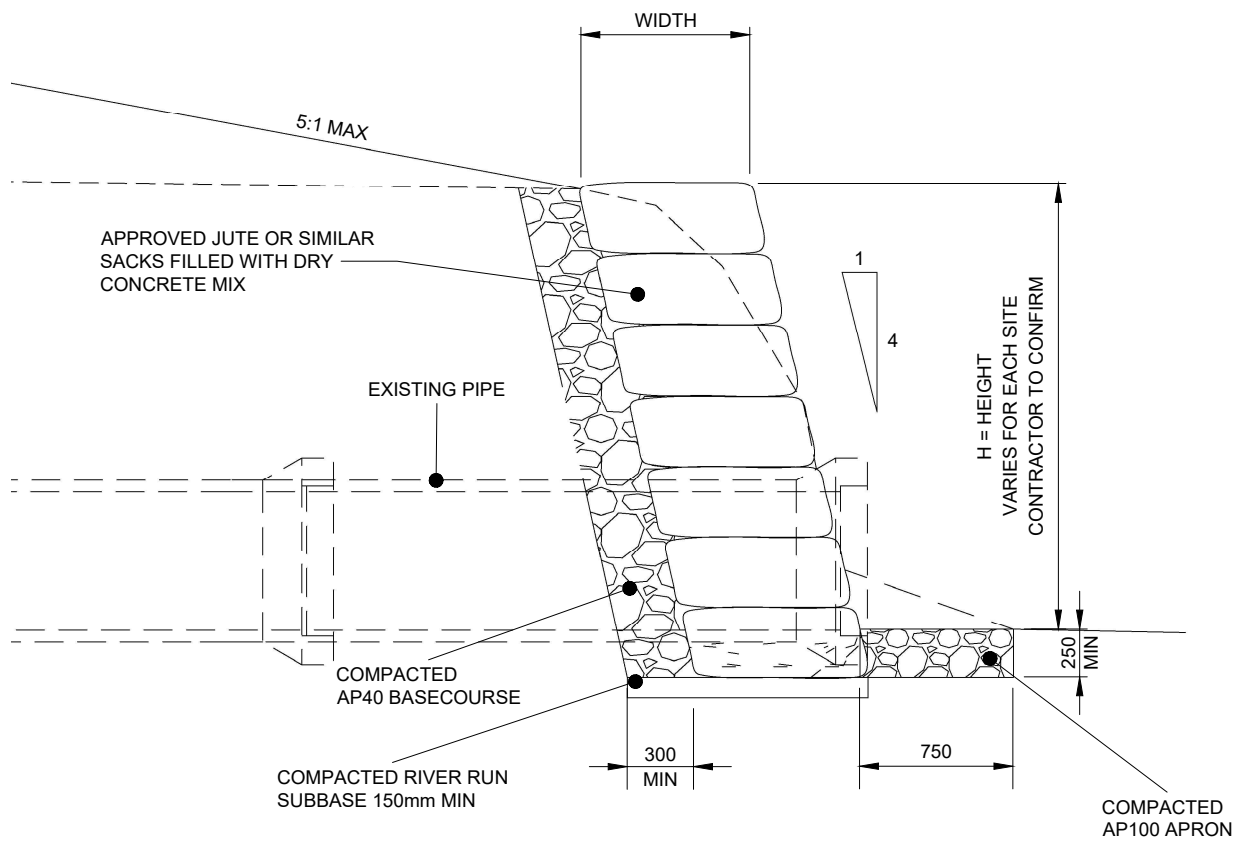

BAGGED CONCRETE HEADWALL DETAIL
NOT TO SCALE

DRAWING USED BY TLA :	TITLE: RURAL CULVERT										ORIGINAL SCALE (A4):	NOT TO SCALE		
	BAGGED CONCRETE HEADWALL AORAKI ROADING COLLABORATION										DRAWING NUMBER:	G-108	REVISION:	A
											SHEET:	2	OF:	2

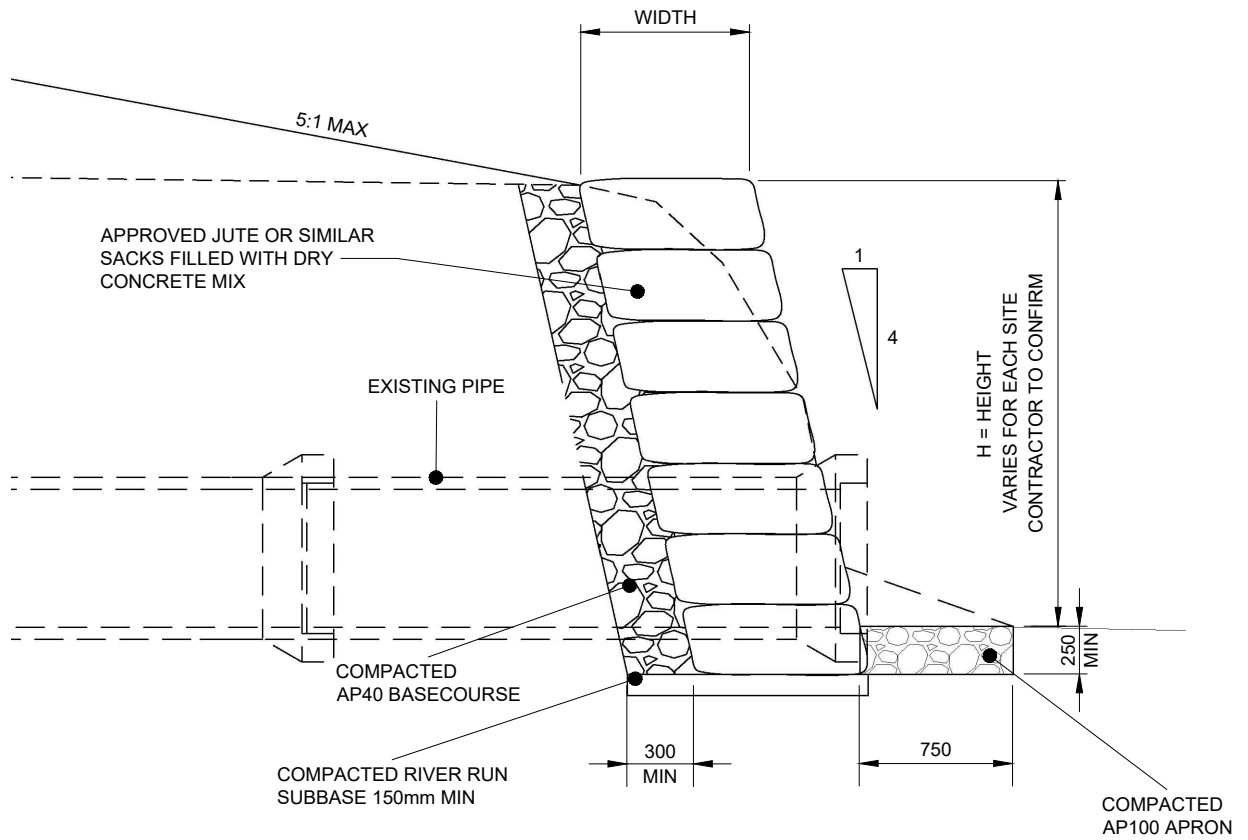

BAGGED CONCRETE HEADWALL DETAIL
NOT TO SCALE

DRAWING ADOPTED BY TLA :

ADC TDC
MDC WDC

No.	REVISION	BY	CHK	APP.	DATE

TITLE:

RURAL CULVERT
BAGGED CONCRETE HEADWALL
AORAKI ROADING COLLABORATION

ORIGINAL SCALE (A4):

NOT TO SCALE

DRAWING NUMBER:

G-108

REVISION:

A

SHEET:

2

OF: 2

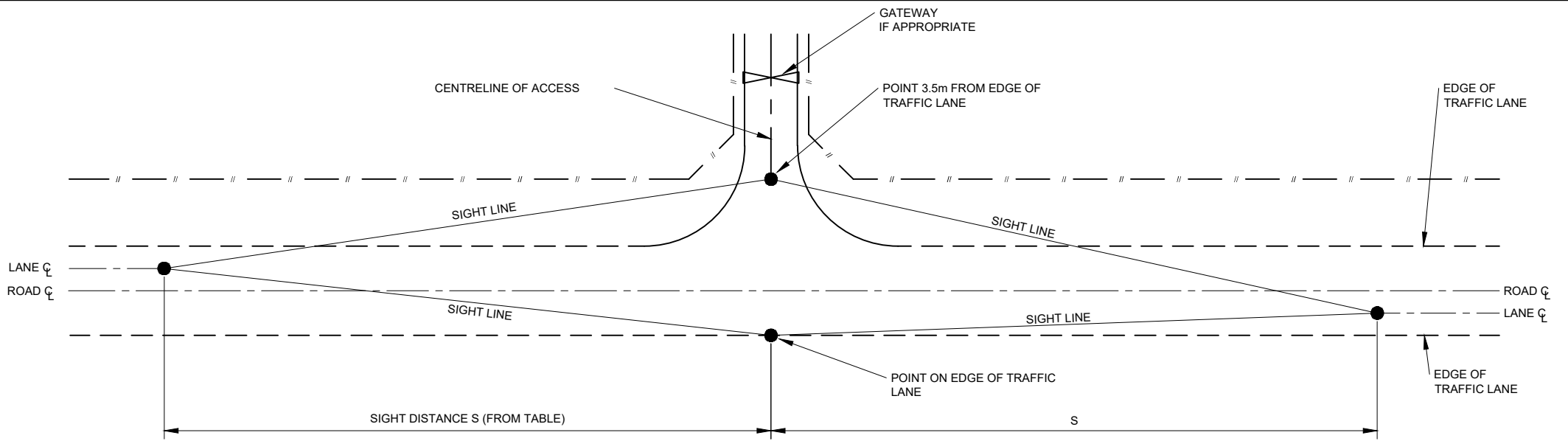

NOTES:

- SIGHT DISTANCES SHALL BE MEASURED TO AND FROM A HEIGHT OF 1.15m ABOVE THE EXISTING ROAD SURFACE AND THE PROPOSED SURFACE LEVEL OF THE SIDE ROAD OR ACCESS. THERE ARE TO BE NO OBSTRUCTIONS TO VISIBILITY INSIDE THE AREA BOUNDED BY THE SIGHT LINES.
- SEE ALSO G-111 SHEET 3 VEGETATION CONTROL - SIGHT DISTANCES AT INTERSECTIONS

POSTED SPEED LIMIT	MINIMUM SIGHT DISTANCE (S) (METRES)	MINIMUM DISTANCE TO EXISTING ACCESS (M) (SAME SIDE OF ROAD)	MINIMUM DISTANCE TO ACCESS LOCATED ON A SECONDARY ROAD TO AN INTERSECTION (M)
50	85	10	10
60	115	15	15
70	140	20	20
80	170	100	30
100	250	200	30

DRAWING USED BY TLA : ADC Y/N TDC Y/N MDC Y/N WDC Y/N	<table border="1" style="width: 100%; height: 40px;"> <tr><td> </td><td> </td><td> </td><td> </td><td> </td><td> </td></tr> <tr><td> </td><td> </td><td> </td><td> </td><td> </td><td> </td></tr> <tr><td> </td><td> </td><td> </td><td> </td><td> </td><td> </td></tr> <tr><td> </td><td> </td><td> </td><td> </td><td> </td><td> </td></tr> <tr><td> </td><td> </td><td> </td><td> </td><td> </td><td> </td></tr> </table>																															TITLE: SIGHT DISTANCE FOR INTERSECTIONS & ACCESSWAYS AORAKI ROADING COLLABORATION	ORIGINAL SCALE (A4): NOT TO SCALE DRAWING NUMBER: G-109 SHEET: 1 OF 1 REVISION: A
A ISSUED FOR CONSTRUCTION BY WHC SD AD 05/20 No REVISION BY CHK APP DATE		DO NOT SCALE - IF IN DOUBT ASK																															

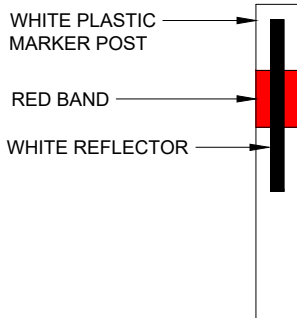

WHITE PLASTIC
MARKER POST

RED BAND

WHITE REFLECTOR

STANDARD MARKER POST

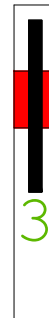

75mm GREEN CLASS 2
ENGINEERS GRADE
REFLECTIVE SELF-ADHESIVE
NUMBER(S) - SERIES B STYLE

STANDARD MARKER POST
WITH CULVERT NUMBER

NOTE:

1. MATERIALS TO BE IN ACCORDANCE WITH THE MAINTENANCE SPECIFICATION

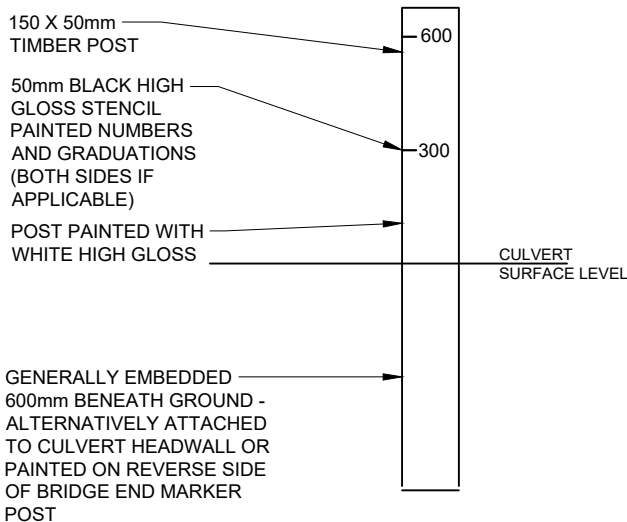

150 X 50mm
TIMBER POST

50mm BLACK HIGH
GLOSS STENCIL
PAINTED NUMBERS
AND GRADUATIONS
(BOTH SIDES IF
APPLICABLE)

POST PAINTED WITH
WHITE HIGH GLOSS

GENERALLY EMBEDDED
600mm BENEATH GROUND -
ALTERNATIVELY ATTACHED
TO CULVERT HEADWALL OR
PAINTED ON REVERSE SIDE
OF BRIDGE END MARKER
POST

CULVERT
SURFACE LEVEL

FORD DEPTH MARKER



GREEN NON-REFLECTIVE BAND

75mm GREEN CLASS 2 ENGINEERS GRADE
REFLECTIVE SELF-ADHESIVE NUMBER(S)
SERIES B STYLE

WHITE PLASTIC MARKER POST

CULVERT MARKER POST

TREATMENT

1. ATTACH THE CULVERT NUMBER DIRECTLY UNDERNEATH THE WHITE REFLECTOR ON ONE SIDE OF THE POST ONLY, FACING THE APPROACHING TRAFFIC IN THE ADJACENT LANE.

INSTALLATION

1. TWO MARKER POSTS AT EACH CULVERT
2. GENERALLY POSITIONED IN THE RANGE OF 1.2 - 3.0m FROM THE SIDE OF THE ADJACENT TRAVEL LANE, OR AS CLOSE AS POSSIBLE TO THE CULVERT PIPE ENDS.
3. THE CULVERT NUMBER SHALL BE ATTACHED TO ONE SIDE OF THE POST ONLY, FACING THE APPROACHING TRAFFIC IN THE ADJACENT LANE.

DRAWING USED
BY TLA :

ADC Y/N TDC Y/N

MDC Y/N WDC Y/N

No.	REVISION	BY	CHK	APP.	DATE
C	TITLE BLOCK UPDATE	WHC	PH	SWD	05/20
B	Issued for Construction	MAT	GRP	SWD	11/15
A	Issued for Combined Maintenance Contract	MAT	GRP	SWD	7/15

TITLE:

SIGNS
MARKER POSTS
AORAKI ROADING COLLABORATION

ORIGINAL SCALE (A4): 1:20

DRAWING NUMBER:

G-110

REVISION:

C

SHEET: 1 OF 3

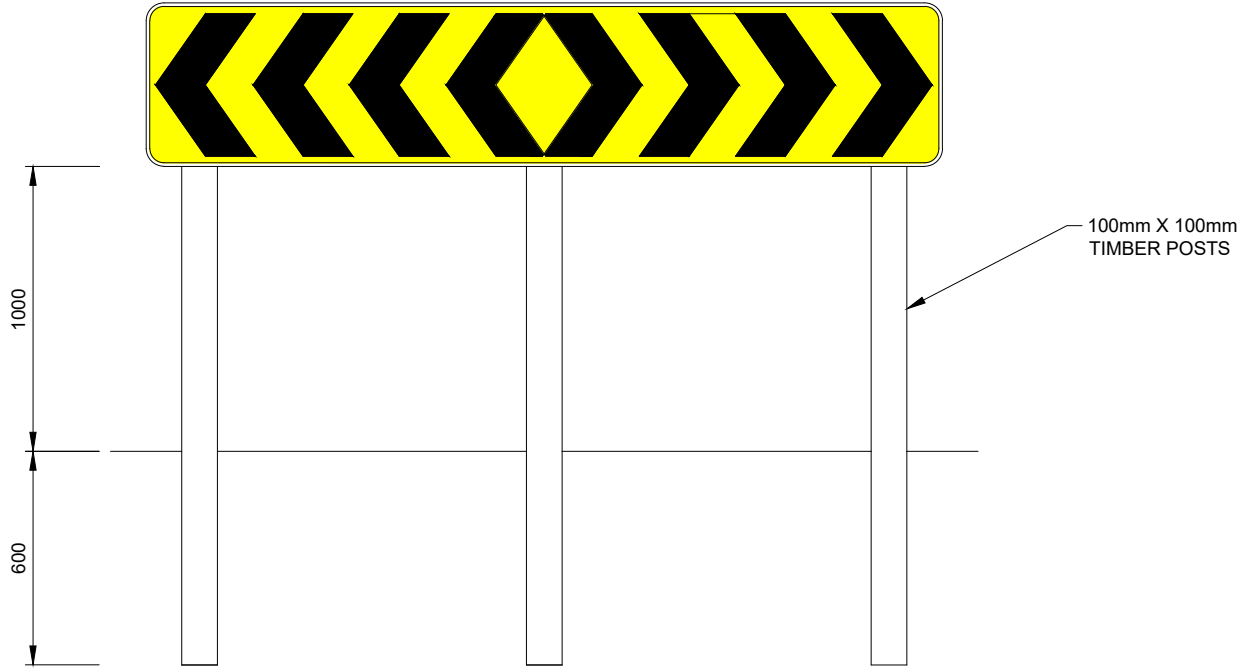

CHEVRON BOARD
REFER TO MOTSAM PW68

NOTE:

1. MATERIALS TO BE IN ACCORDANCE WITH THE MAINTENANCE SPECIFICATION

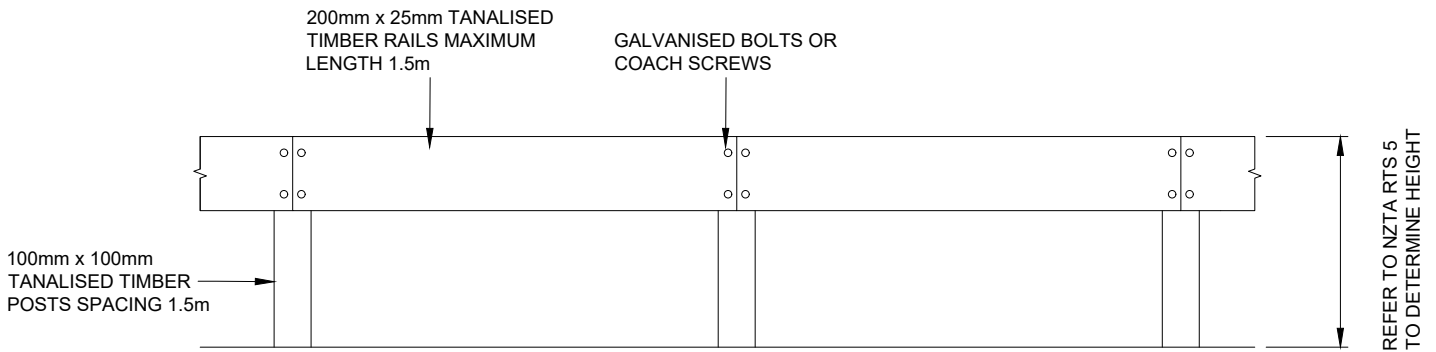

SIGHT RAIL
REFER TO RTS 5 NZTA

DRAWING USED BY TLA : ADC Y/N TDC Y/N MDC Y/N WDC Y/N	TITLE: SIGNS								ORIGINAL SCALE (A4):	NOT TO SCALE
	CHEVRON BOARDS & SIGHT RAILS								DRAWING NUMBER:	REVISION:
	AORAKI ROADING COLLABORATION								G-110	C
									SHEET: 2	OF: 3

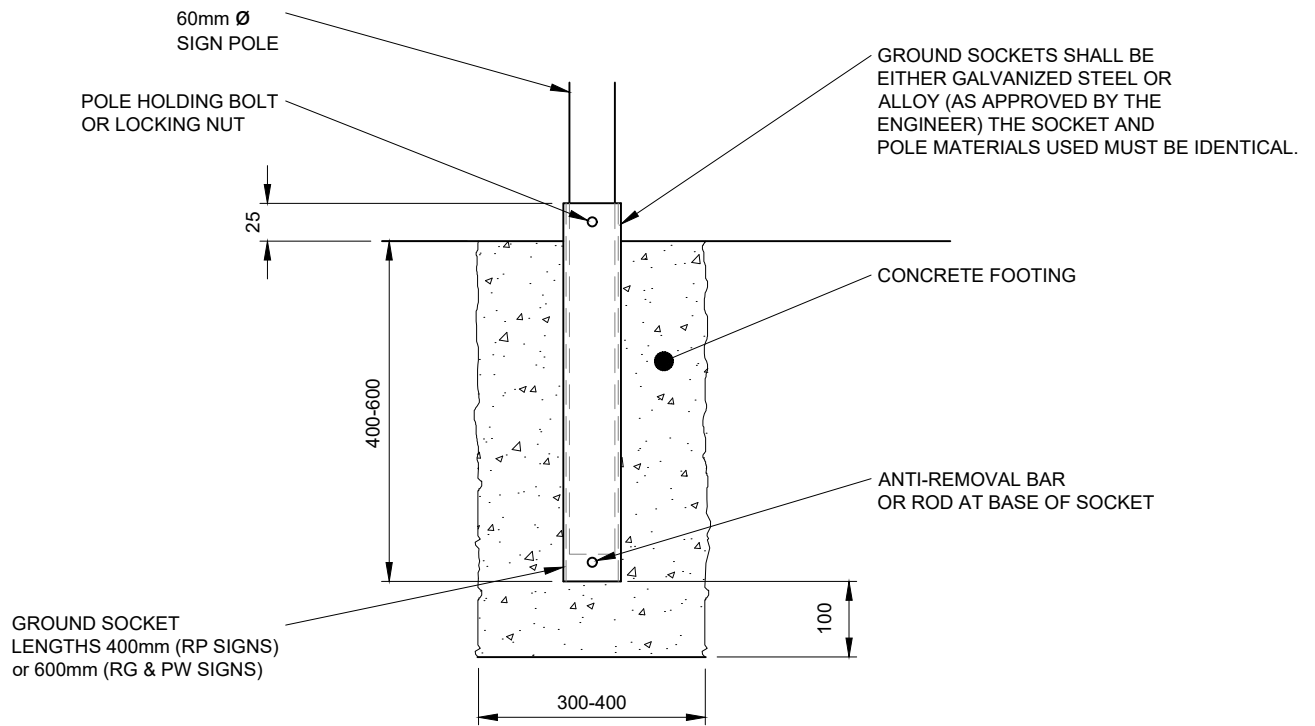

SIGN POLE GROUND SOCKET

NOTES:

1. GROUND SOCKETS INSTALLED IN COBBLESTONE AREAS SHALL HAVE THE COBBLESTONES CUT IMMEDIATELY AROUND THE SOCKET.
2. MATERIALS TO BE IN ACCORDANCE WITH THE MAINTENANCE SPECIFICATION.

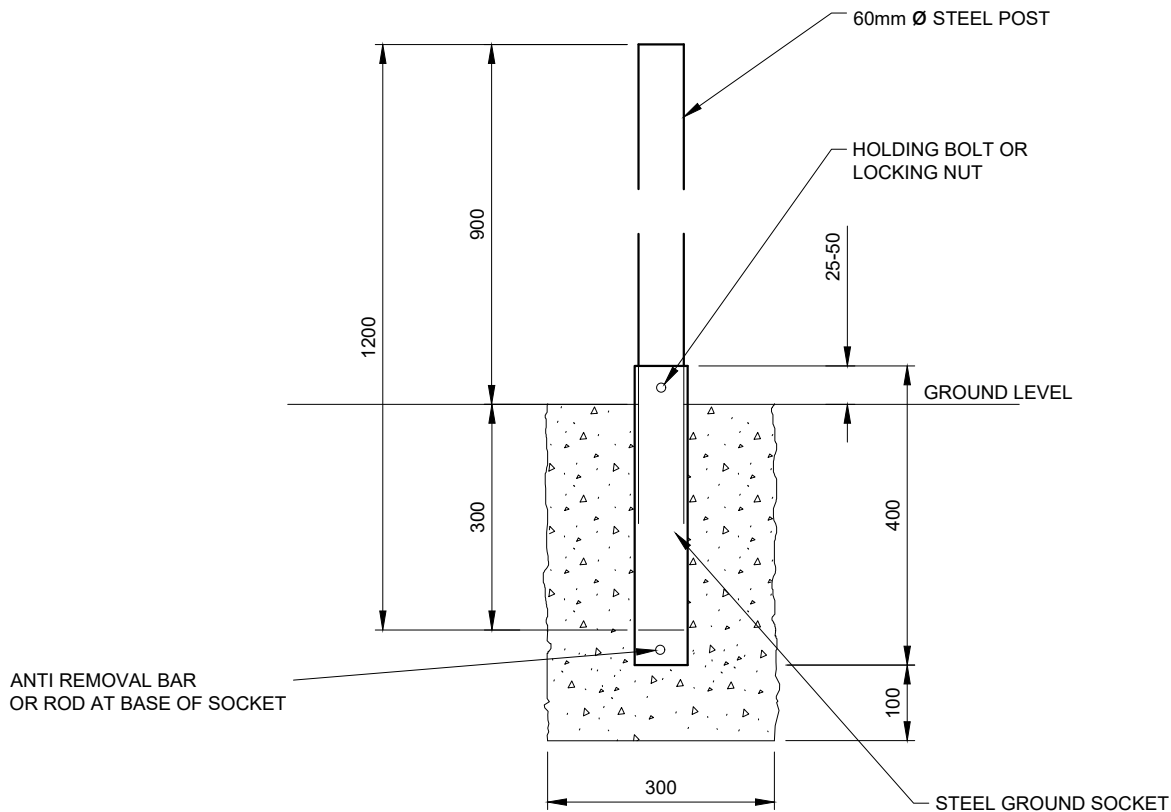

PARKING METER POST

DRAWING USED
BY TLA :
ADC Y/N TDC Y/N
MDC Y/N WDC Y/N

C	TITLE BLOCK UPDATE	WHC	PH	SWD	05/20
B	Issued for Construction	MAT	GRP	SWD	11/15
A	Issued for Combined Maintenance Contract	MAT	GRP	SWD	7/15
No.	REVISION	BY	CHK	APP.	DATE

TITLE: **SIGN POLE GROUND SOCKET
& PARKING METER POST**
AORAKI ROADING COLLABORATION

ORIGINAL SCALE (A4):	1:20
DRAWING NUMBER:	G-110
REVISION:	C
SHEET:	3 OF 3

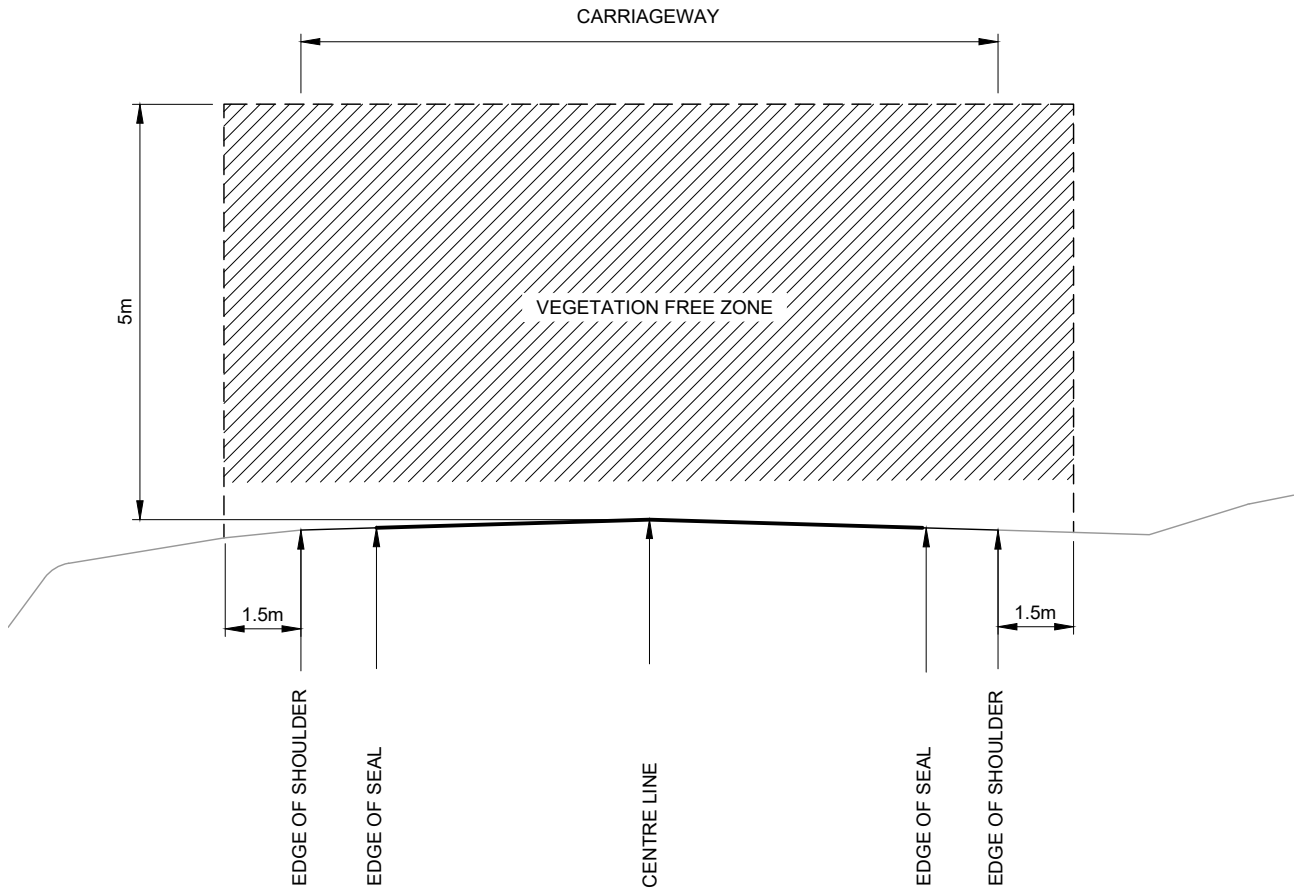

DRAWING USED
BY TLA :
ADC Y/N TDC Y/N
MDC Y/N WDC Y/N

No.	REVISION	BY	CHK	APP	DATE
C	TITLE BLOCK UPDATE		WHC	PH	SWD 0520
B	Issued for Construction		MAT	GRP	SWD 11/15
A	Issued for Combined Maintenance Contract		MAT	GRP	SWD 7/15

TITLE:

**VEGETATION CONTROL
FOR RURAL ROAD CORRIDOR**
AORAKI ROADING COLLABORATION

ORIGINAL SCALE (A4): NOT TO SCALE

DRAWING NUMBER:

G-111

REVISION:

C

SHEET: 1 OF 3

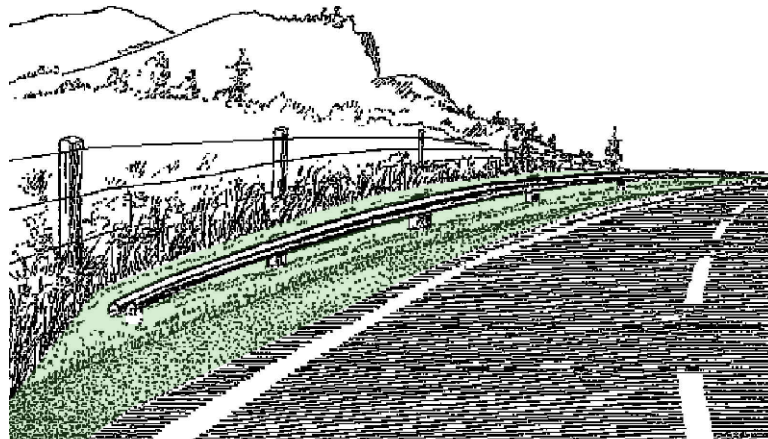
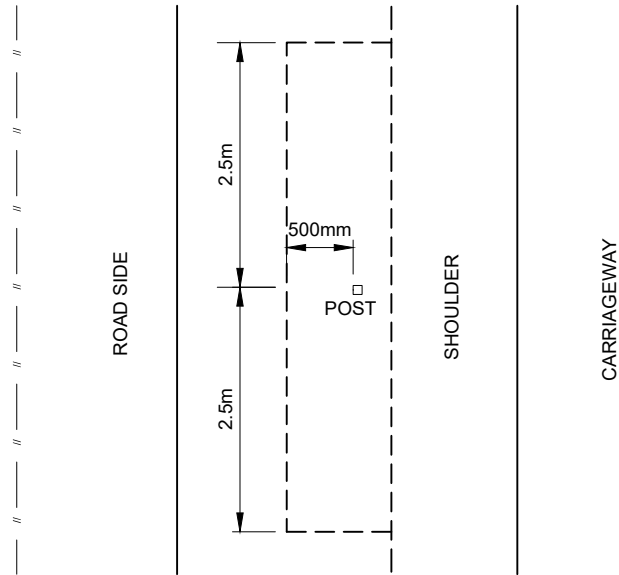

DRAWING USED
BY TLA :
ADC Y/N TDC Y/N
MDC Y/N WDC Y/N

C	TITLE BLOCK UPDATE	WHC	PH	SWD	05/20		
B	Issued for Construction	MAT	GRP	SWD	11/15		
A	Issued for Combined Maintenance Contract	MAT	GRP	SWD	7/15		
No.	REVISION	BY	CHK	APP	DATE		

TITLE:
**VEGETATION CONTROL
AROUND MARKER POST & GUARD RAIL**
AORAKI ROADING COLLABORATION

ORIGINAL SCALE (A4):	NOT TO SCALE
DRAWING NUMBER:	REVISION:
G-111	C
SHEET: 2	OF: 3

NOTE:
SEE ALSO G-109 SIGHT DISTANCE FOR
INTERSECTION AND ACCESSWAYS

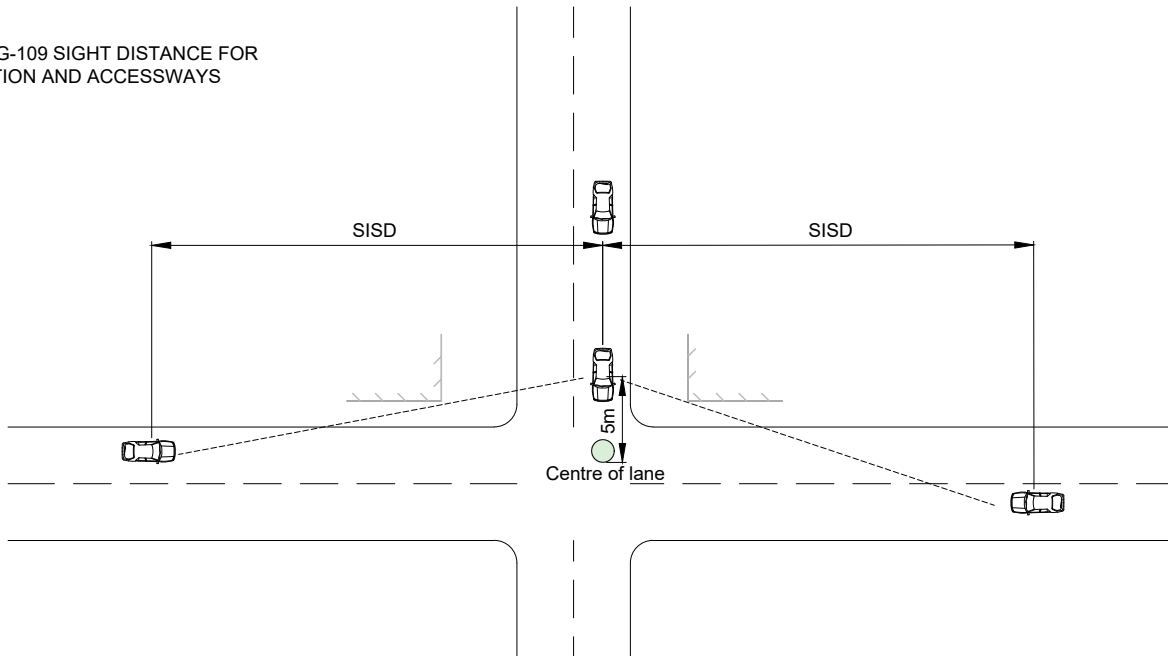

SISD = SAFE INTERSECTION SIGHT DISTANCE

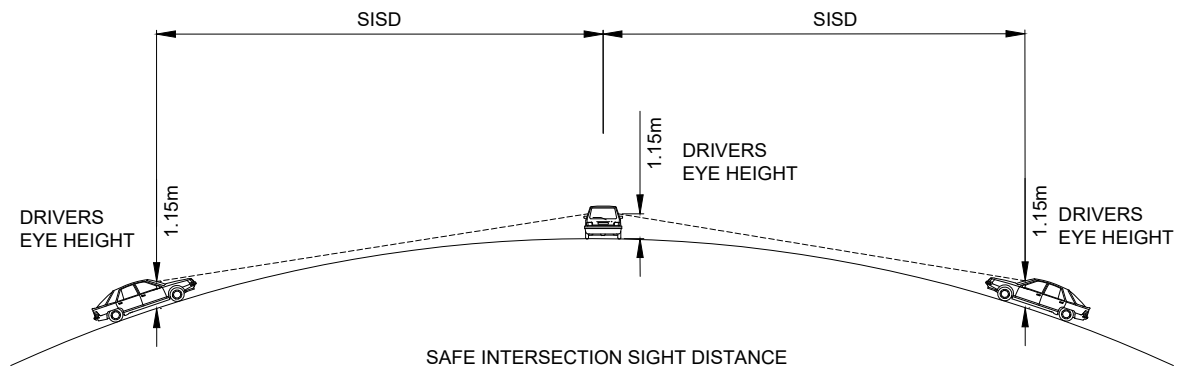

SAFE INTERSECTION SIGHT DISTANCE

SAFE INTERSECTION SIGHT DISTANCE (SISD)

OPERATING SPEED (km/hr)	SAFE INTERSECTION SIGHT (m)	
	RURAL RT = 2.0s	URBAN RT = 1.5s
40	70	60
50	90	80
60	115	105
70	140	130
80	175	165
90	210	
100	250	
110	290	
120	330	

NOTE THAT DISTANCES ASSUME:

- LEVEL PAVEMENTS
- MINOR ROAD VEHICLE STOPPED 5M MINIMUM BACK FROM CONFLICT POINT
- MEASUREMENT ALONG CENTRE OF LANE OF MAJOR ROAD VEHICLE
- SITE DISTANCE SHALL BE MEASURED TO AND FROM A HEIGHT OF 1.15M ABOVE ROAD SURFACE
- VEGETATION CONTROL TO MAINTAIN A MINIMUM SIGHT DISTANCE AT ALL INTERSECTIONS

DRAWING USED
BY TLA :
ADC Y/N TDC Y/N
MDC Y/N WDC Y/N

No.	REVISION	BY	CHK	APP.	DATE
C	TITLE BLOCK UPDATE		WHC	PH	SWD 05/20
B	Issued for Construction		MAT	GRP	SWD 11/15
A	Issued for Combined Maintenance Contract		MAT	GRP	SWD 7/15

TITLE: **VEGETATION CONTROL
SIGHT DISTANCES AT INTERSECTIONS**
AORAKI ROADING COLLABORATION

ORIGINAL SCALE (A4): NOT TO SCALE

DRAWING NUMBER: **G-111** REVISION: **C**
SHEET: 3 OF 3

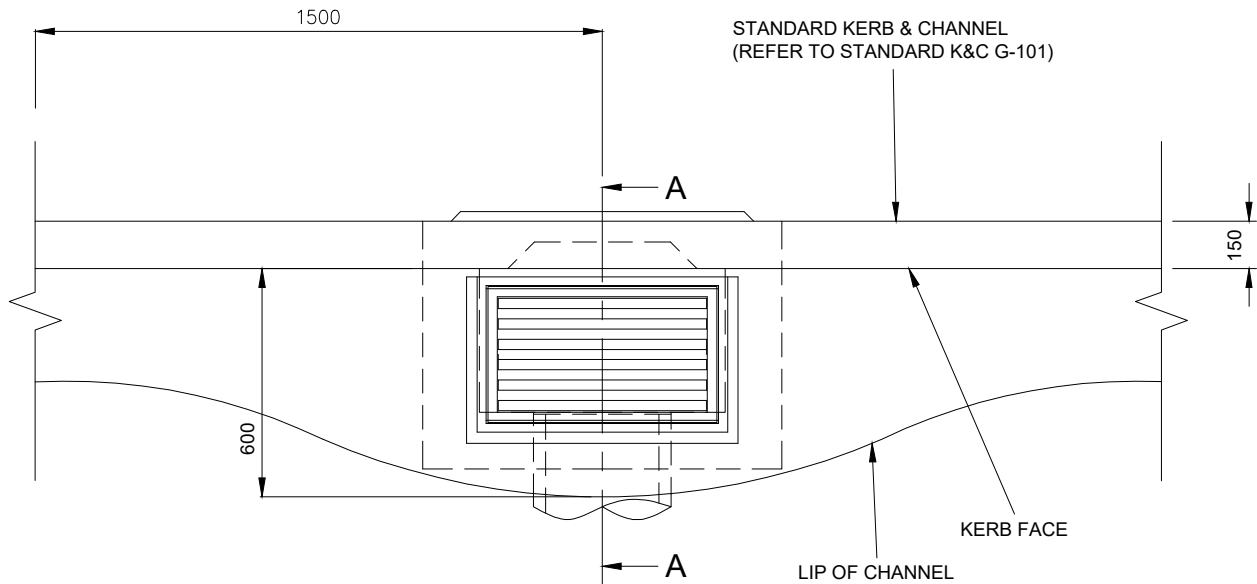

PLAN

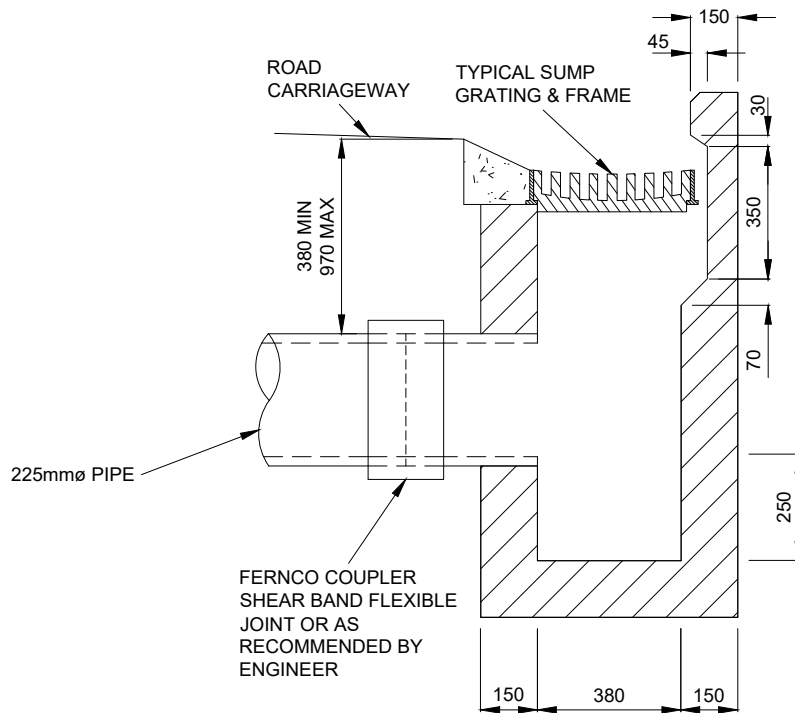

SECTION A-A

NOTES

1. USE HUMES PRECAST UNITS (OR SIMILAR APPROVED) IN CONJUNCTION WITH STANDARD SUMP GRATING AND FRAME.
2. ALL STORMWATER LATERALS TO BE LAID AT -1.0% MINIMUM GRADE.
3. CONCRETE STRENGTH 25 MPA
4. SEE TDC DRAINAGE & WATER STANDARD DETAILS DRAWING 5302 SHEET 8 FOR A DOUBLE STORMWATER SUMP

DRAWING USED BY TLA : ADC Y/N TDC Y/N MDC Y/N WDC Y/N	<table border="1" style="width: 100%; border-collapse: collapse;"> <tr> <td style="width: 5%;">C</td> <td style="width: 45%;">TEXT UPDATED</td> <td style="width: 10%;">MAT</td> <td style="width: 10%;">SD</td> <td style="width: 10%;">AD</td> <td style="width: 10%;">05/20</td> </tr> <tr> <td>B</td> <td>ISSUED FOR CONSTRUCTION</td> <td>MAT</td> <td>GRP</td> <td>SWD</td> <td>11/15</td> </tr> <tr> <td>A</td> <td>ISSUED FOR MAINTENANCE CONTRACT</td> <td>MAT</td> <td>GRP</td> <td>SWD</td> <td>7/15</td> </tr> <tr> <td>No.</td> <td>REVISION</td> <td>BY</td> <td>CHK</td> <td>APP.</td> <td>DATE</td> </tr> </table>	C	TEXT UPDATED	MAT	SD	AD	05/20	B	ISSUED FOR CONSTRUCTION	MAT	GRP	SWD	11/15	A	ISSUED FOR MAINTENANCE CONTRACT	MAT	GRP	SWD	7/15	No.	REVISION	BY	CHK	APP.	DATE	TITLE: SINGLE STORMWATER SUMP AORAKI ROADING COLLABORATION	ORIGINAL SCALE (A4): NTS DRAWING NUMBER: <div style="font-size: 2em; font-weight: bold; text-align: center;">G-112</div> <div style="font-size: 3em; font-weight: bold; text-align: right;">C</div> SHEET 1 OF 1
C	TEXT UPDATED	MAT	SD	AD	05/20																						
B	ISSUED FOR CONSTRUCTION	MAT	GRP	SWD	11/15																						
A	ISSUED FOR MAINTENANCE CONTRACT	MAT	GRP	SWD	7/15																						
No.	REVISION	BY	CHK	APP.	DATE																						

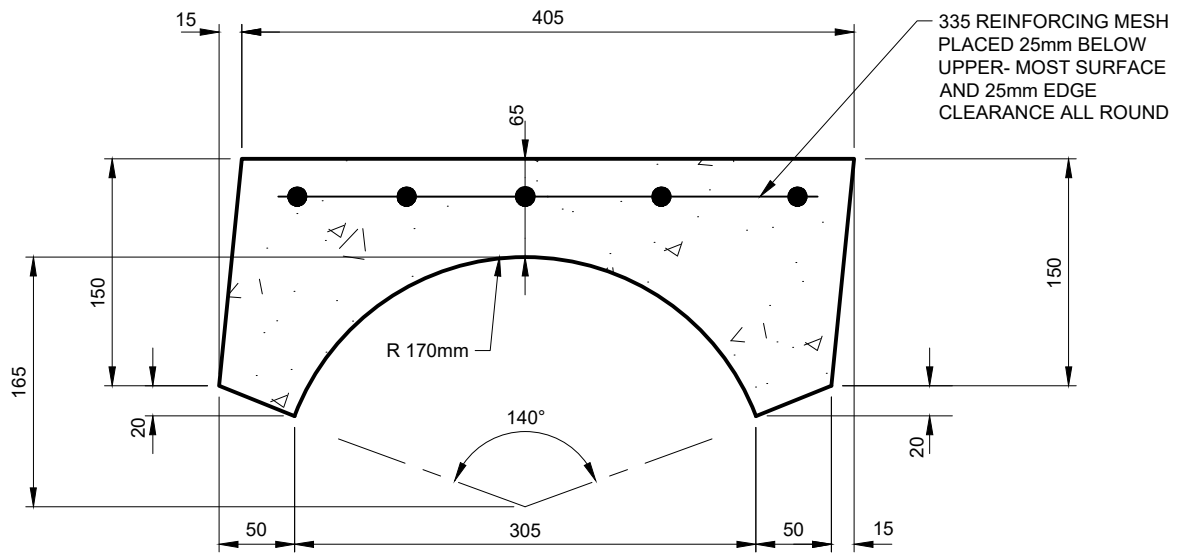

MEDIUM ROUND BRIDGE BLOCK

NOTES:

1. UNITS SHALL BE 750mm LONG
2. CONCRTE TO BE NZS 3109 WITH A 28 DAY STRENGTH OF 20mPa

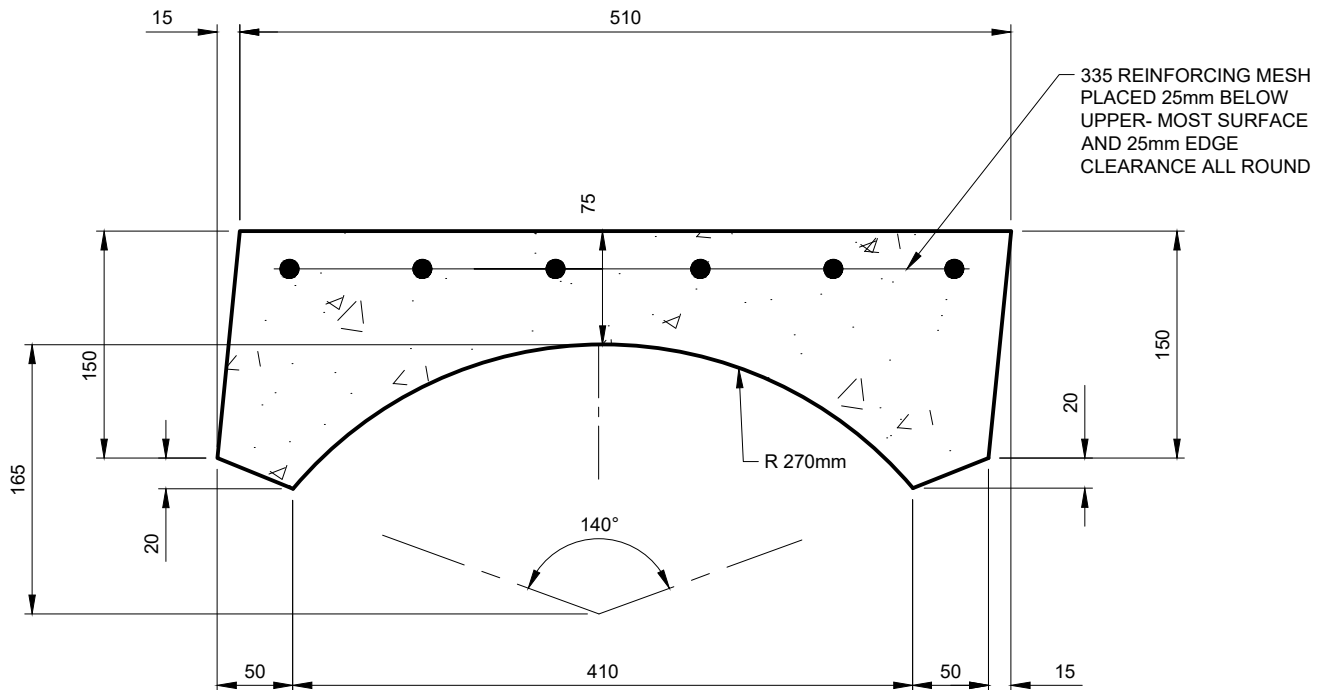

LARGE ROUND BRIDGE BLOCK

DRAWING USED
BY TLA :
ADC Y/N TDC Y/N
MDC Y/N WDC Y/N

No.	REVISION	BY	CHK	APP.	DATE
C	TITLE BLOCK UPDATE	WHC	SD	AD	05/20
B	Issued for Construction	MAT	GRP	SWD	11/15
A	Issued for Combined Maintenance Contract	MAT	GRP	SWD	7/15

TITLE:

**KERB & CHANNEL
BRIDGE BLOCKS**
AORAKI ROADING COLLABORATION

ORIGINAL SCALE (A4): 1:5

DRAWING NUMBER:

G-201

REVISION:

C

SHEET: 1 OF 1

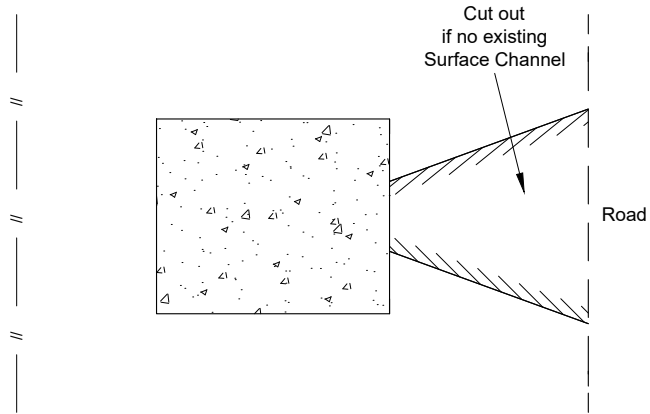

PLAN

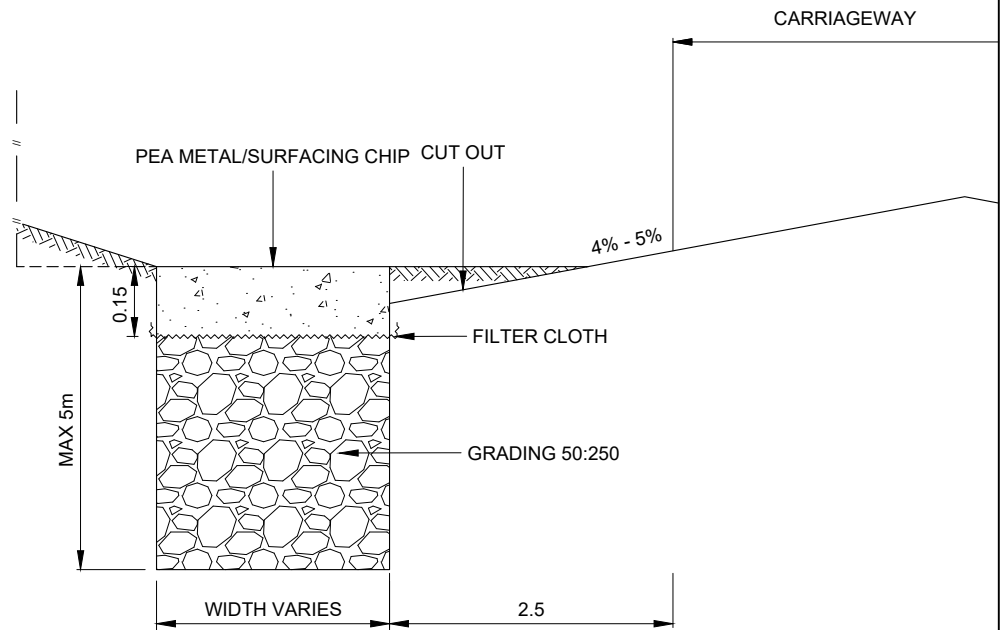

CROSS SECTION

DRAWING USED BY TLA :						TITLE: SOAK PIT - RURAL AORAKI ROADING COLLABORATION	ORIGINAL SCALE (A4):	NOT TO SCALE	
	ADC Y/N	TDC Y/N					DRAWING NUMBER:	G-202	REVISION:
	MDC Y/N	WDC Y/N						1	C
								OF	2
								SHEET:	

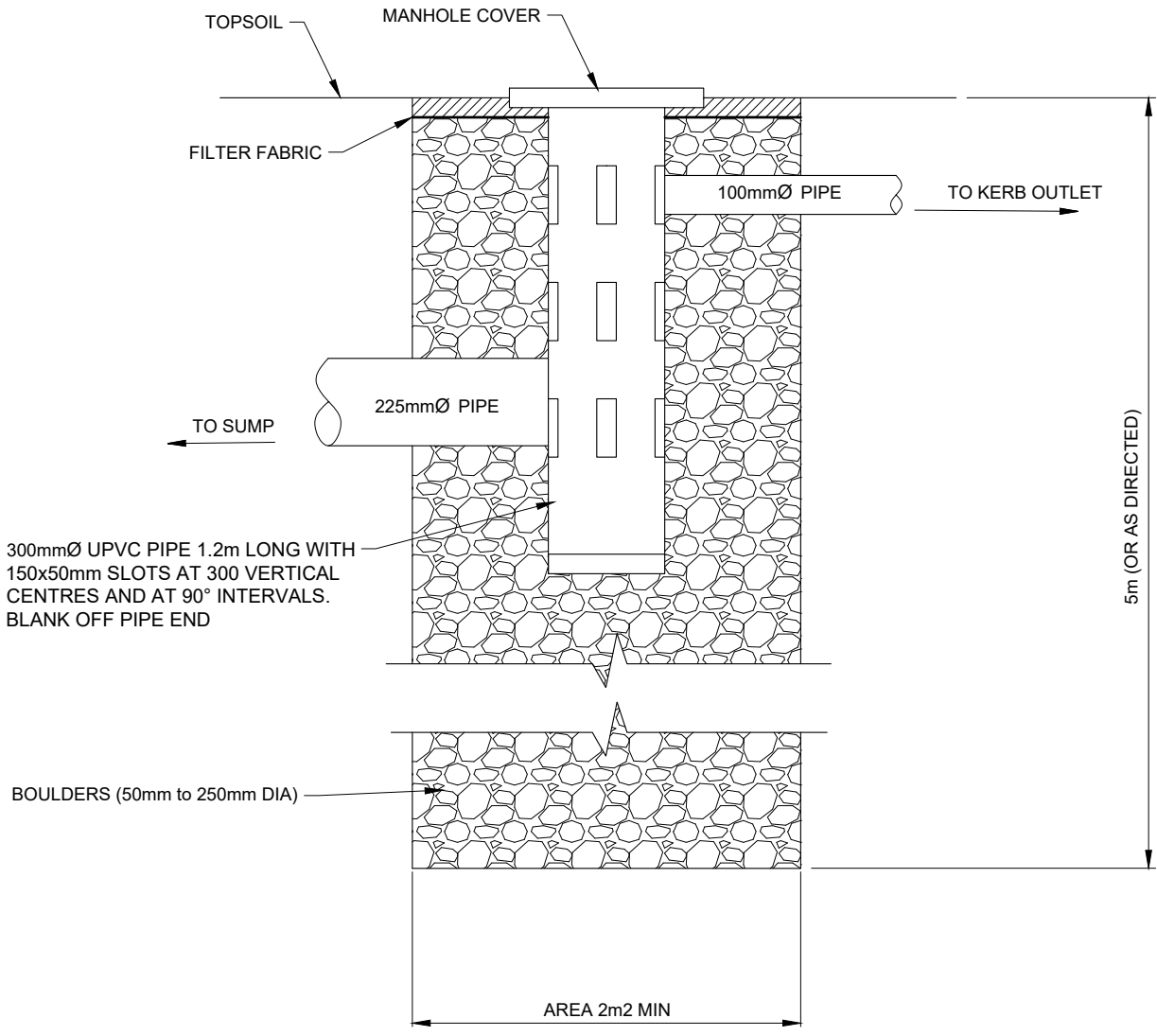

DETAIL
NOT TO SCALE

DRAWING USED BY TLA :						TITLE: SOAK PIT - URBAN AORAKI ROADING COLLABORATION	ORIGINAL SCALE (A4):	NOT TO SCALE	
	ADC Y/N	TDC Y/N					DRAWING NUMBER:	G-202	REVISION:
	MDC Y/N	WDC Y/N							A
	A	NEW DRAWING	MAT	SD	AD		05/20	SHEET:	
No.	REVISION	BY	CHK	APP	DATE				

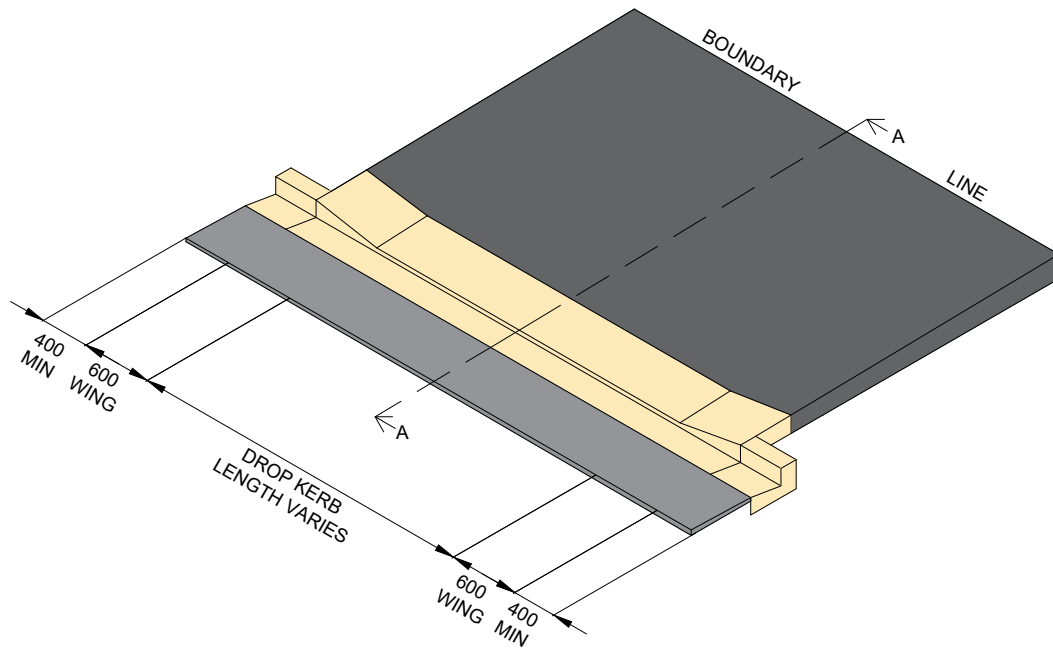

VEHICLE KERB CROSSING - LIGHT COMMERCIAL DROP
NOT TO SCALE

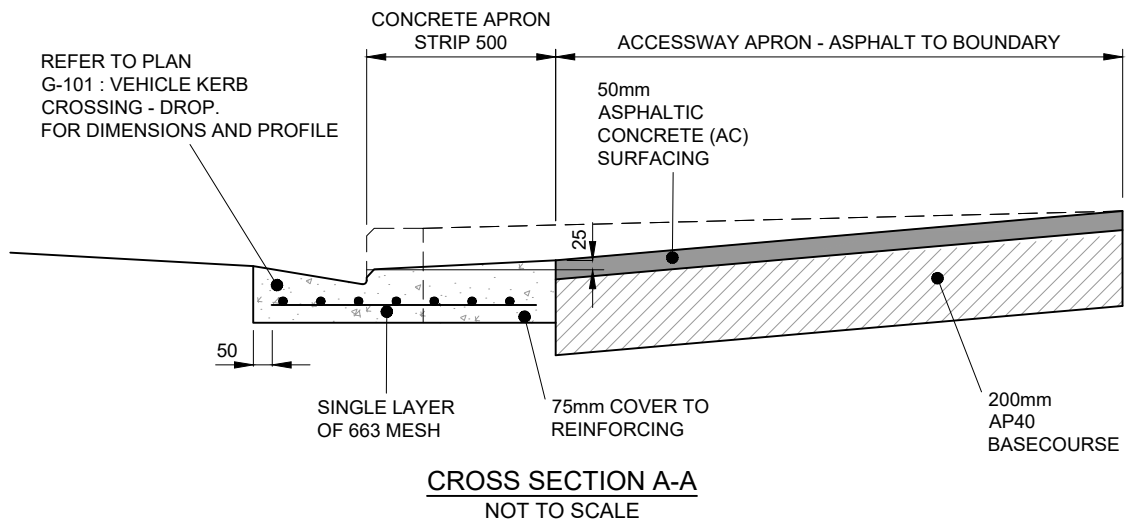

NOTES:

1. SINGLE LAYER OF 'REINFORCING MESH' IS TO BE 663 STEEL MESH
2. CONCRETE TO BE NZS 3109 WITH A 38 DAY STRENGTH OF 30MPa
3. A BASECOURSE LAYER UNDER THE KERB & CHANNEL AND APRON MUST BE 150mm AP40 M/4 COMPACTED TO TNZ B/2
4. SCALA TEST THE SUBGRADE SURFACE TO ACHIEVE A CBR OF 7 MINIMUM
5. SHOULD THE SUBBASE MATERIAL BE UNSUITABLE A 150mm MINIMUM DEPTH OF AP65 MUST BE LAID AND COMPACTED TO A MAXIMUM DEPTH OF 1m BELOW THE FINISHED SURFACE OF THE CROSSING.

DRAWING USED BY TLA :					TITLE: VEHICLE KERB CROSSING - LIGHT COMMERCIAL DROP AORAKI ROADING COLLABORATION	ORIGINAL SCALE (A4):	NTS	
	ADC Y/N	TDC Y/N	MDC Y/N	WDC Y/N		DRAWING NUMBER:	G-203	
							A	
						SHEET: 1	OF: 1	

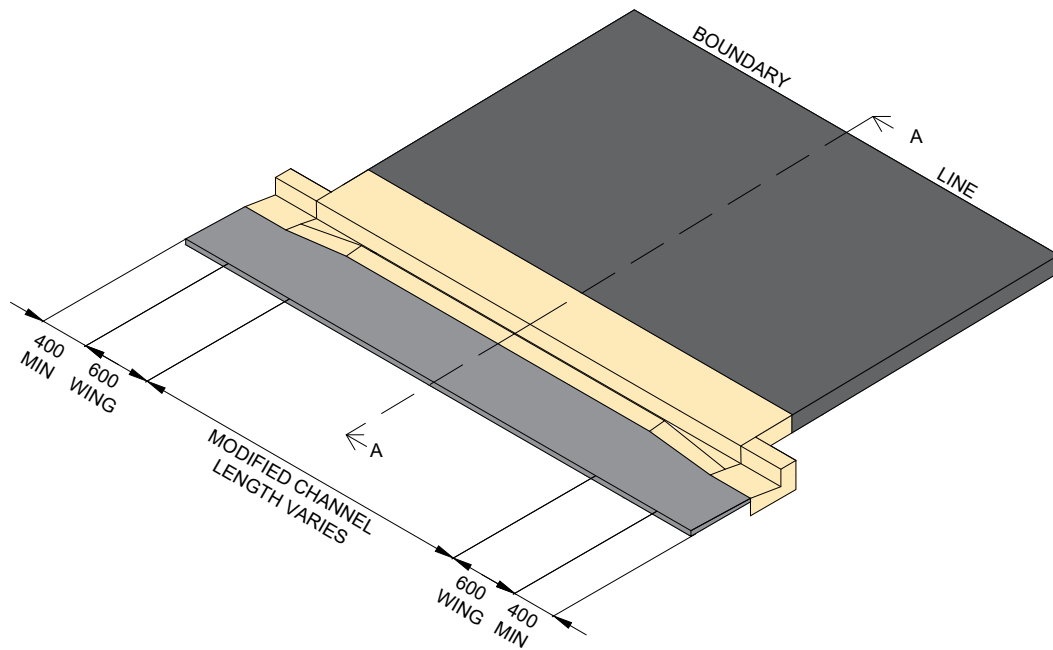

VEHICLE KERB CROSSING - LIGHT COMMERCIAL MODIFIED
NOT TO SCALE

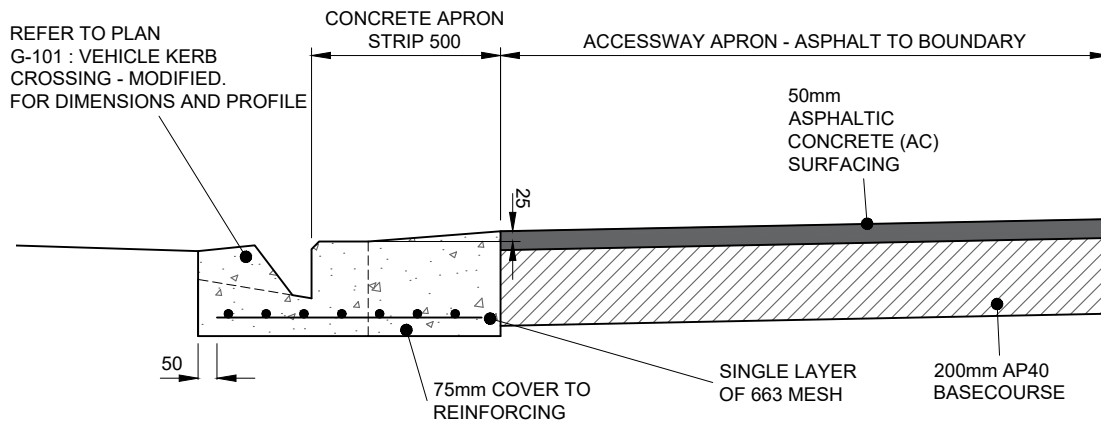

CROSS SECTION A-A
NOT TO SCALE

NOTES:

1. SINGLE LAYER OF 'REINFORCING MESH' IS TO BE 663 STEEL MESH
2. CONCRETE TO BE NZS 3109 WITH A 38 DAY STRENGTH OF 30MPa
3. A BASECOURSE LAYER UNDER THE KERB & CHANNEL AND APRON MUST BE 150mm AP40 M/4 COMPACTED TO TNZ B/2
4. SCALA TEST THE SUBGRADE SURFACE TO ACHIEVE A CBR OF 7 MINIMUM
5. SHOULD THE SUBBASE MATERIAL BE UNSUITABLE A 150mm MINIMUM DEPTH OF AP65 MUST BE LAID AND COMPACTED TO A MAXIMUM DEPTH OF 1m BELOW THE FINISHED SURFACE OF THE CROSSING.

DRAWING USED BY TLA : ADC Y/N TDC Y/N MDC Y/N WDC Y/N		VEHICLE KERB CROSSING - LIGHT COMMERCIAL MODIFIED AORAKI ROADING COLLABORATION	ORIGINAL SCALE (A4): NTS														
	<table border="1" style="width: 100%; border-collapse: collapse;"> <tr> <td style="width: 5%;">No.</td> <td style="width: 15%;">REVISION</td> <td style="width: 5%;">MAT</td> <td style="width: 5%;">SD</td> <td style="width: 5%;">AD</td> <td style="width: 10%;">04/20</td> </tr> <tr> <td></td> <td></td> <td>BY</td> <td>CHK</td> <td>APP.</td> <td>DATE</td> </tr> </table>		No.	REVISION	MAT	SD	AD	04/20			BY	CHK	APP.	DATE	<table border="1" style="width: 100%; border-collapse: collapse;"> <tr> <td style="width: 80%; text-align: center; font-size: 24pt;">G-204</td> <td style="width: 20%; text-align: center; font-size: 24pt;">A</td> </tr> <tr> <td style="text-align: center;">SHEET: 1</td> <td style="text-align: center;">OF: 1</td> </tr> </table>	G-204	A
No.	REVISION	MAT	SD	AD	04/20												
		BY	CHK	APP.	DATE												
G-204	A																
SHEET: 1	OF: 1																

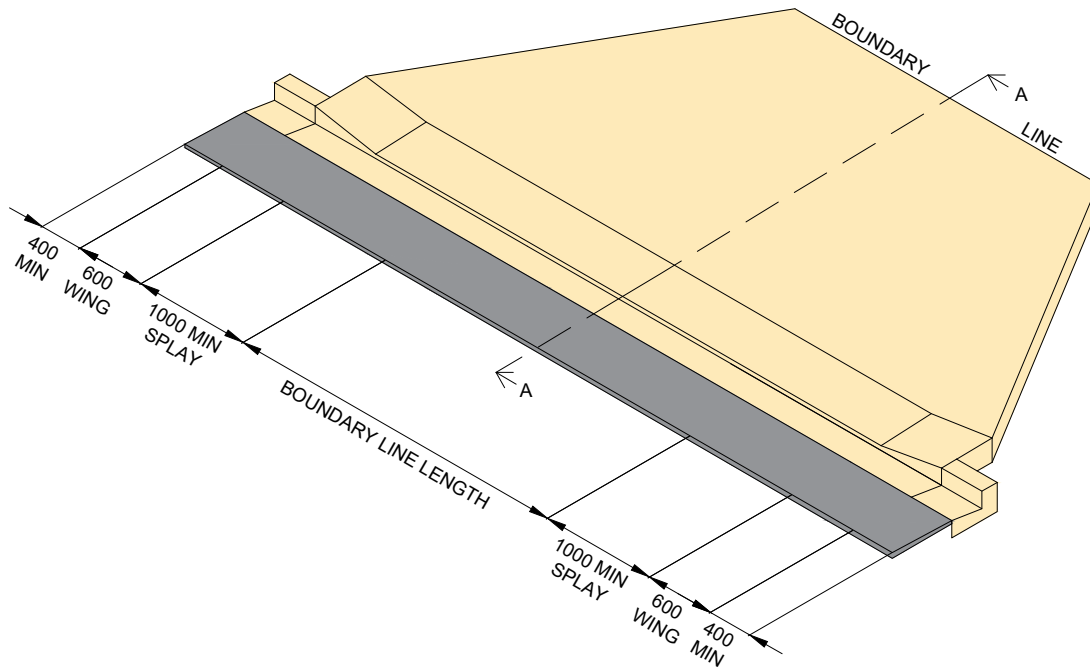

VEHICLE KERB CROSSING - HEAVY COMMERCIAL DROP
NOT TO SCALE

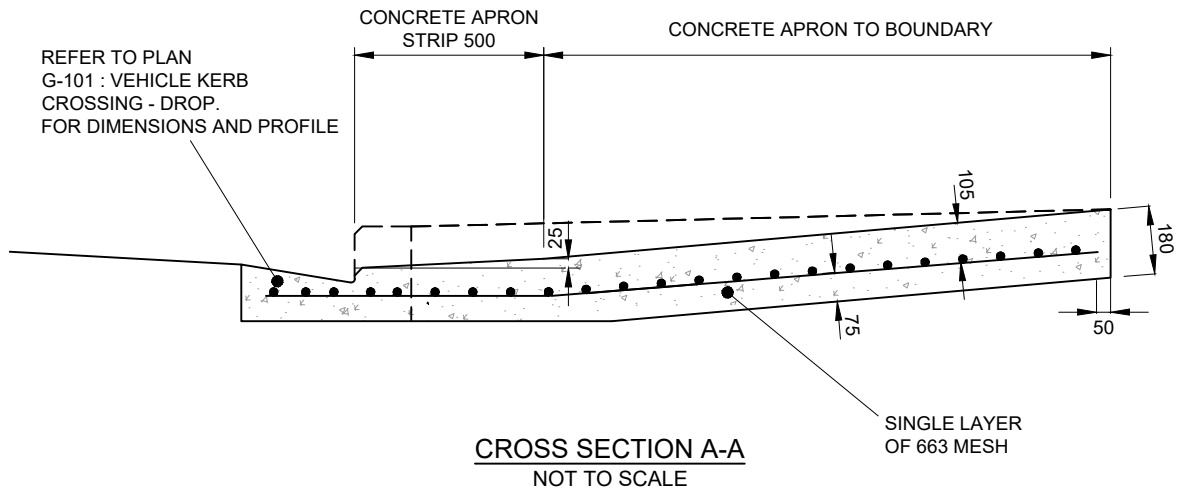

CROSS SECTION A-A
NOT TO SCALE

NOTES:

1. SINGLE LAYER OF 'REINFORCING MESH' IS TO BE 663 STEEL MESH
2. CONCRETE TO BE NZS 3109 WITH A 28 DAY STRENGTH OF 30MPa
3. A BASECOURSE LAYER UNDER THE KERB & CHANNEL AND APRON MUST BE 150mm AP40 M/4 COMPACTED TO TNZ B/2
4. SCALA TEST THE SUBGRADE SURFACE TO ACHIEVE A CBR OF 7 MINIMUM
5. SHOULD THE SUBBASE MATERIAL BE UNSUITABLE A 150mm MINIMUM DEPTH OF AP65 MUST BE LAID AND COMPACTED TO A MAXIMUM DEPTH OF 1m BELOW THE FINISHED SURFACE OF THE CROSSING.

DRAWING USED BY TLA :					TITLE: VEHICLE KERB CROSSING - HEAVY COMMERCIAL DROP AORAKI ROADING COLLABORATION	ORIGINAL SCALE (A4):	NTS	
	ADC Y/N	TDC Y/N	MDC Y/N	WDC Y/N		DRAWING NUMBER:	G-205	
							A	
						SHEET:	1 OF 1	

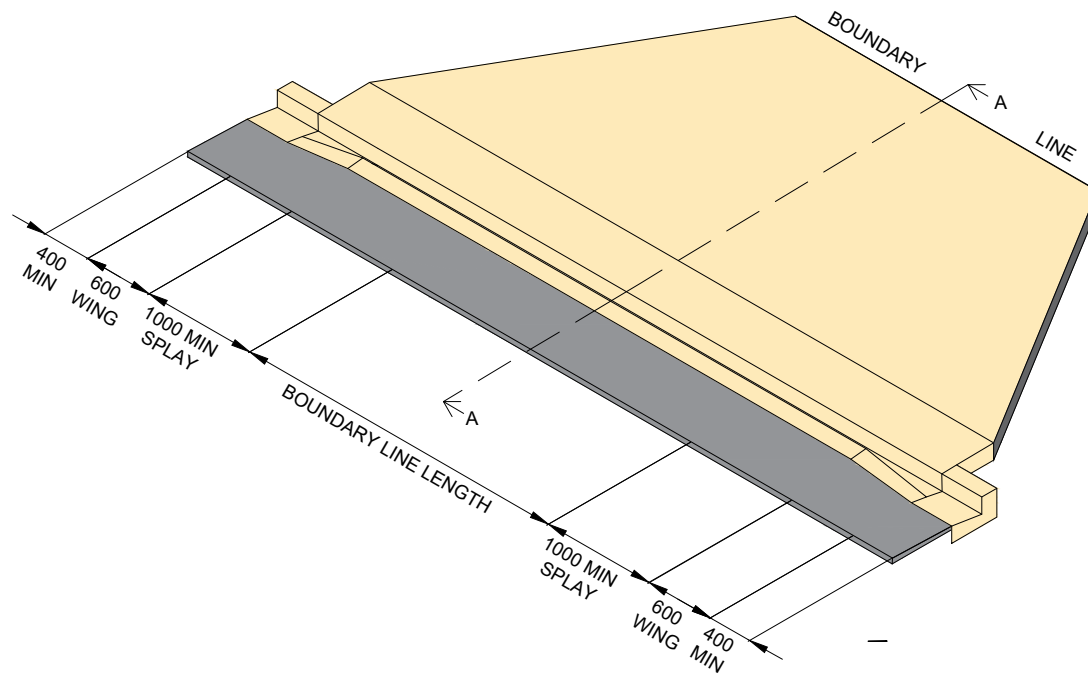

VEHICLE KERB CROSSING - HEAVY COMMERCIAL MODIFIED
NOT TO SCALE

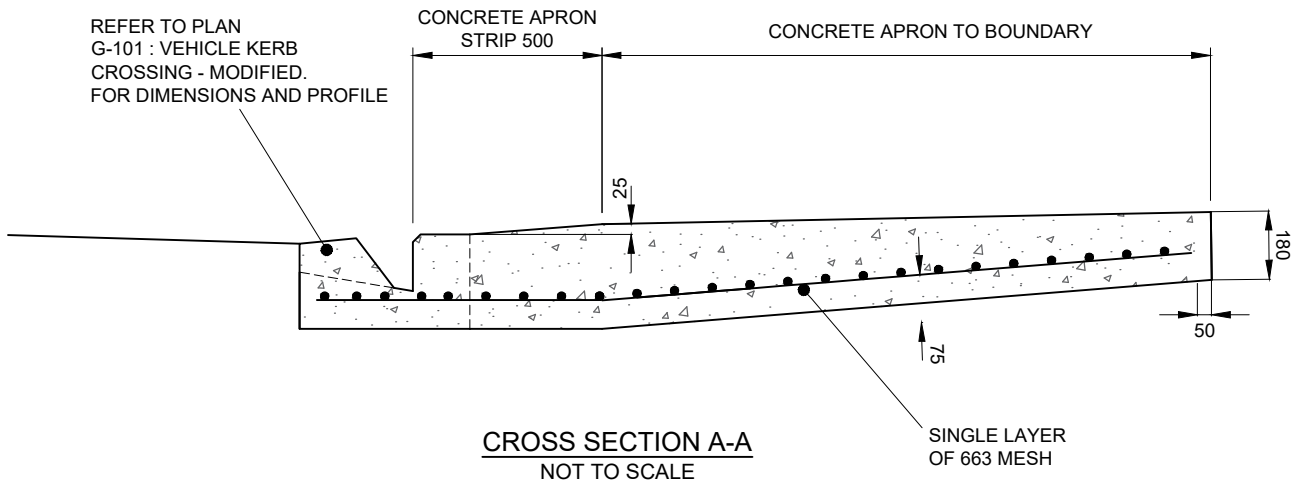

CROSS SECTION A-A
NOT TO SCALE

NOTES:

1. SINGLE LAYER OF 'REINFORCING MESH' IS TO BE 663 STEEL MESH
2. CONCRETE TO BE NZS 3109 WITH A 28 DAY STRENGTH OF 30MPa
3. A BASECOURSE LAYER UNDER THE KERB & CHANNEL AND APRON MUST BE 150mm AP40 M/4 COMPACTED TO TNZ B/2
4. SCALA TEST THE SUBGRADE SURFACE TO ACHIEVE A CBR OF 7 MINIMUM
5. SHOULD THE SUBBASE MATERIAL BE UNSUITABLE A 150mm MINIMUM DEPTH OF AP65 MUST BE LAID AND COMPACTED TO A MAXIMUM DEPTH OF 1m BELOW THE FINISHED SURFACE OF THE CROSSING.

DRAWING USED BY TLA :					TITLE: VEHICLE KERB CROSSING - HEAVY COMMERCIAL MODIFIED AORAKI ROADING COLLABORATION	ORIGINAL SCALE (A4):	NTS												
	ADC Y/N	TDC Y/N	MDC Y/N	WDC Y/N		DRAWING NUMBER: G-206	REVISION: A												
<table border="1"> <thead> <tr> <th>No.</th> <th>REVISION</th> <th>BY</th> <th>CHK</th> <th>APP.</th> <th>DATE</th> </tr> </thead> <tbody> <tr> <td>A</td> <td>NEW DRAWING</td> <td></td> <td></td> <td></td> <td>05/20</td> </tr> </tbody> </table>					No.	REVISION	BY	CHK	APP.	DATE	A	NEW DRAWING				05/20	SHEET:	1	OF 1
No.	REVISION	BY	CHK	APP.	DATE														
A	NEW DRAWING				05/20														

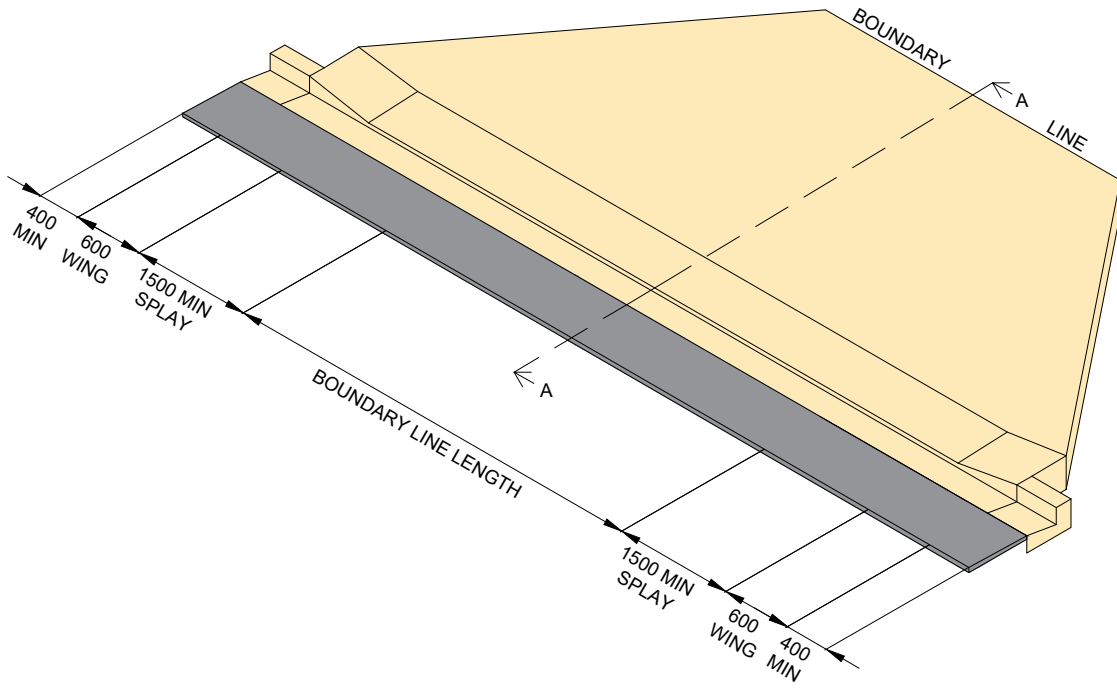

VEHICLE KERB CROSSING - INDUSTRIAL DROP
NOT TO SCALE

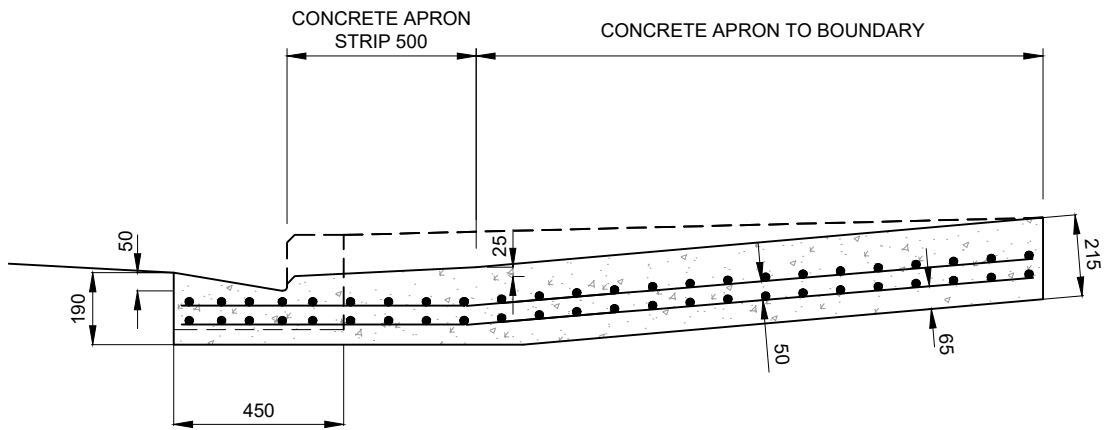

CROSS SECTION A-A
NOT TO SCALE

NOTES:

1. DUAL LAYERS OF 'REINFORCING MESH' ARE TO BE 663 STEEL MESH
2. CONCRETE TO BE NZS 3109 WITH A 28 DAY STRENGTH OF 30MPa
3. A BASECOURSE LAYER UNDER THE KERB & CHANNEL AND APRON MUST BE 150mm AP40 M/4 COMPACTED TO TNZ B/2
4. SCALA TEST THE SUBGRADE SURFACE TO ACHIEVE A CBR OF 7 MINIMUM
5. SHOULD THE SUBBASE MATERIAL BE UNSUITABLE A 150mm MINIMUM DEPTH OF AP65 MUST BE LAID AND COMPACTED TO A MAXIMUM DEPTH OF 1m BELOW THE FINISHED SURFACE OF THE CROSSING.

DRAWING USED BY TLA :					TITLE: VEHICLE KERB CROSSING - INDUSTRIAL DROP AORAKI ROADING COLLABORATION	ORIGINAL SCALE (A4):	NTS												
	ADC Y/N	TDC Y/N	MDC Y/N	WDC Y/N		DRAWING NUMBER:	G-207												
<table border="1"> <thead> <tr> <th>No.</th> <th>REVISION</th> <th>BY</th> <th>CHK</th> <th>APP.</th> <th>DATE</th> </tr> </thead> <tbody> <tr> <td>A</td> <td>NEW DRAWING</td> <td></td> <td></td> <td></td> <td>05/20</td> </tr> </tbody> </table>					No.	REVISION	BY	CHK	APP.	DATE	A	NEW DRAWING				05/20	SHEET:	1	OF 1
No.	REVISION	BY	CHK	APP.	DATE														
A	NEW DRAWING				05/20														
							A												

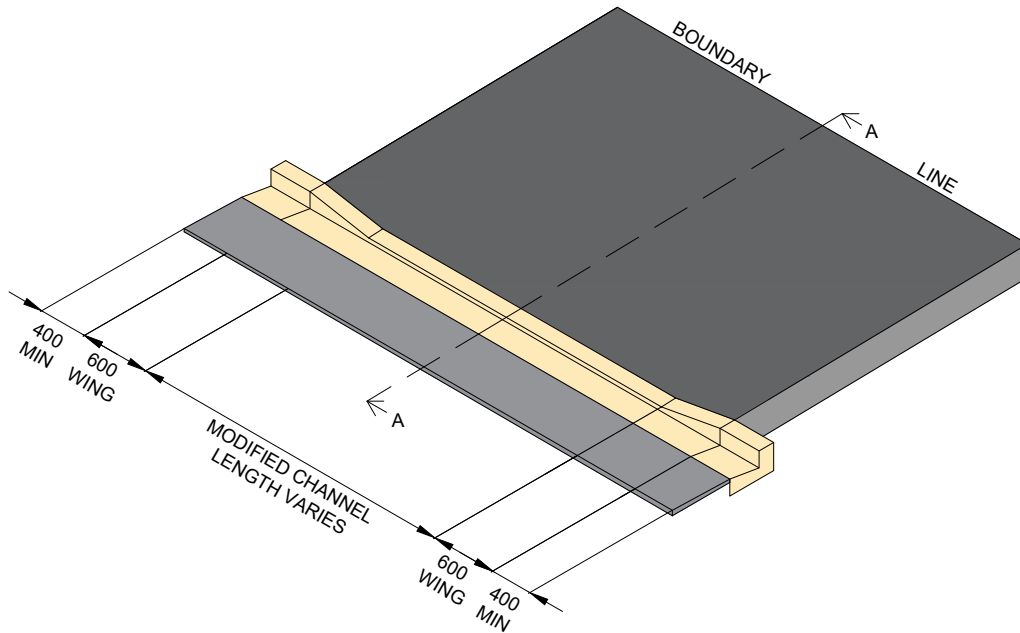

VEHICLE KERB CROSSING - INDUSTRIAL DROP WITH ASPHALTIC CONCRETE (AC)
NOT TO SCALE

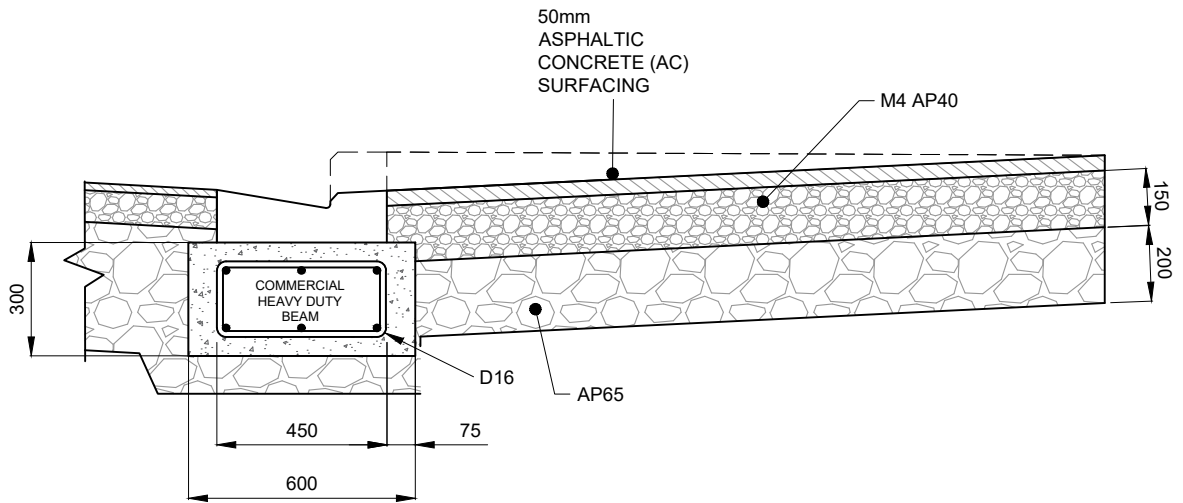

CROSS SECTION A-A
NOT TO SCALE

NOTES:

1. DUAL LAYERS OF 'REINFORCING MESH' ARE TO BE 663 STEEL MESH
2. CONCRETE TO BE NZS 3109 WITH A 38 DAY STRENGTH OF 30MPa
3. A BASECOURSE LAYER UNDER THE KERB & CHANNEL AND APRON MUST BE 150mm AP40 M/4 COMPACTED TO TNZ B/2
4. SCALA TEST THE SUBGRADE SURFACE TO ACHIEVE A CBR OF 7 MINIMUM
5. SHOULD THE SUBBASE MATERIAL BE UNSUITABLE A 150mm MINIMUM DEPTH OF AP65 MUST BE LAID AND COMPACTED TO A MAXIMUM DEPTH OF 1m BELOW THE FINISHED SURFACE OF THE CROSSING.
6. HEAVY DUTY REINFORCING BEAM TO EXTEND 1.5m FROM END OF DROP TRANSITION

DRAWING USED BY TLA :					TITLE: VEHICLE KERB CROSSING - INDUSTRIAL DROP WITH AC AORAKI ROADING COLLABORATION	ORIGINAL SCALE (A4):	NTS	
	ADC Y/N	TDC Y/N	MDC Y/N	WDC Y/N		DRAWING NUMBER:	G-209	
							A	
						SHEET:	1 OF 1	