

LEGEND

- Land boundaries
- Land designated as "STATE HIGHWAY"
- Land to be designated as "ROADING PURPOSES-Secondary Designation" Area = 0.2ha
- Land to be designated for "ROADING PURPOSES" (Total Area = 9.1ha)

- | | |
|--|---|
| <p>A Pt RS 39368
J.P. & M.A. Edkins*
Area = 1.8ha</p> <p>B Lot 2 DP 28415
CB10B/990
Ashburton District Council
Area = 0.1ha</p> <p>C Lot 1 DP 28415
CB10B/989
Ashburton District Council
Area = 2.9ha</p> <p>D Lot 2 DP 78926
CB45B/626
R.J. & C.A. Nelson
Area = 0.2ha</p> <p>E Lot 1 DP 78926
CB45B/625
R.J. & C.A. Nelson
Area = 0.1ha</p> | <p>F Res 4433 CB475/118
Ashburton District Council
Area = 1.7ha</p> <p>G Lot 1 DP 46816
CB26A/332
CMP Canterbury Ltd
Area = 0.1ha</p> <p>H Lot 1 DP 352761
Rural Transport Ltd
Area = 0.3ha</p> <p>J Pt Res 4041
Ashburton District Council
Area = 1.5ha</p> <p>K Lot 1 DP 352761
Rural Transport
Area = 0.2ha</p> <p>L Pt Res 4041
Ashburton District Council
Area = 0.2ha</p> |
|--|---|

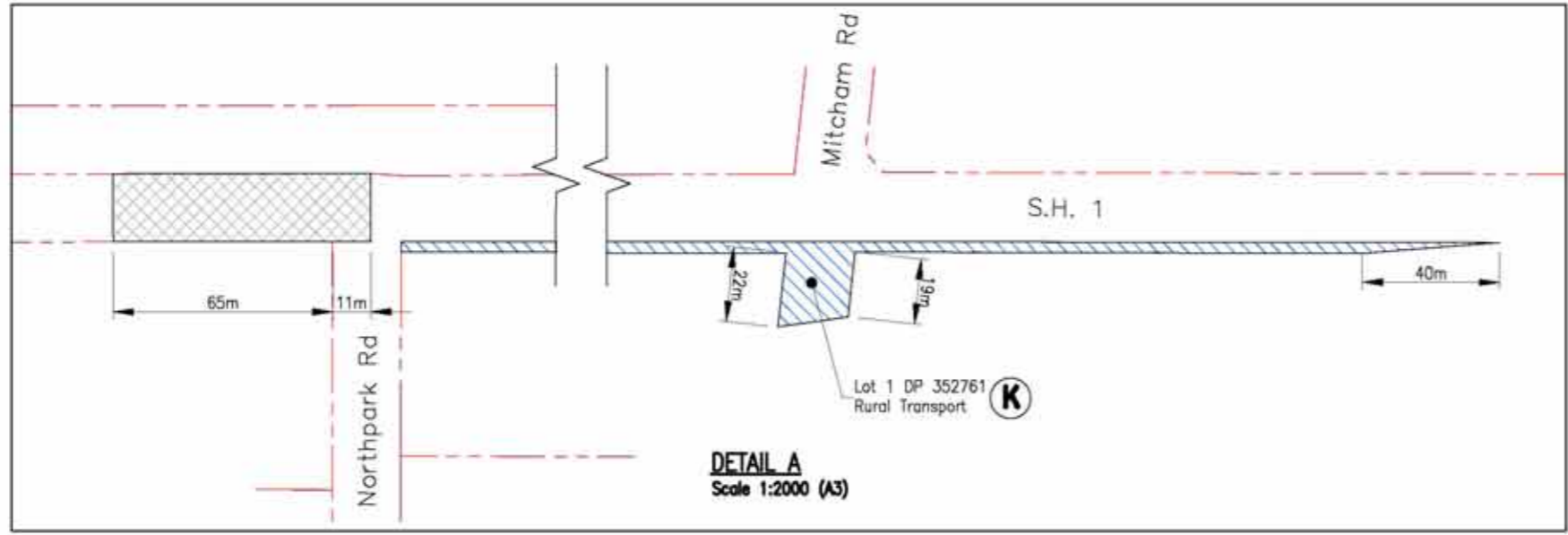

AMENDMENT	APP'D	DATE	BY	CHECKED	DATE

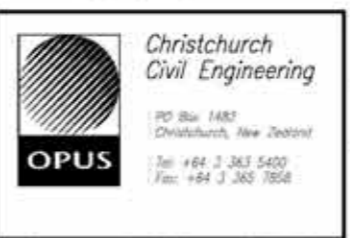
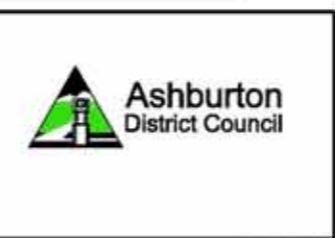

TITLE RESOURCE MANAGEMENT ACT 1991 ASHBURTON DISTRICT PLAN NOTICE OF REQUIREMENT UNDER SECTION 168 S.H. 1/NORTH PARK ROAD INTERCHANGE LAND DESIGNATION PLAN					
STATUS	DRAFT	FILE	3CW350.00		
SCALE	1:4000 @ A3	PLOT DATE	06/12/06 @ 08:10	FEATURE IDENTIFIER	6/619/60
		CODE	3604	SHEET	1
		REVISION			