



**COMPUTER FREEHOLD REGISTER
UNDER LAND TRANSFER ACT 1952**



Search Copy

R. W. Muir
Registrar-General
of Land

Identifier **CB6B/745**
Land Registration District **Canterbury**
Date Issued 22 July 1966

Prior References

CB89/287

Estate Fee Simple
Area 2.0234 hectares more or less
Legal Description Lot 1 Deposited Plan 24680

Proprietors

Barry James Redmond

Interests

A27251.3 Mortgage to Bank of New Zealand - 7.12.1992 at 9.33 am
7441380.3 Variation of Mortgage A27251.3 - 29.6.2007 at 9:00 am

LAND TRANSFER ACT 1954

665 1000 1100

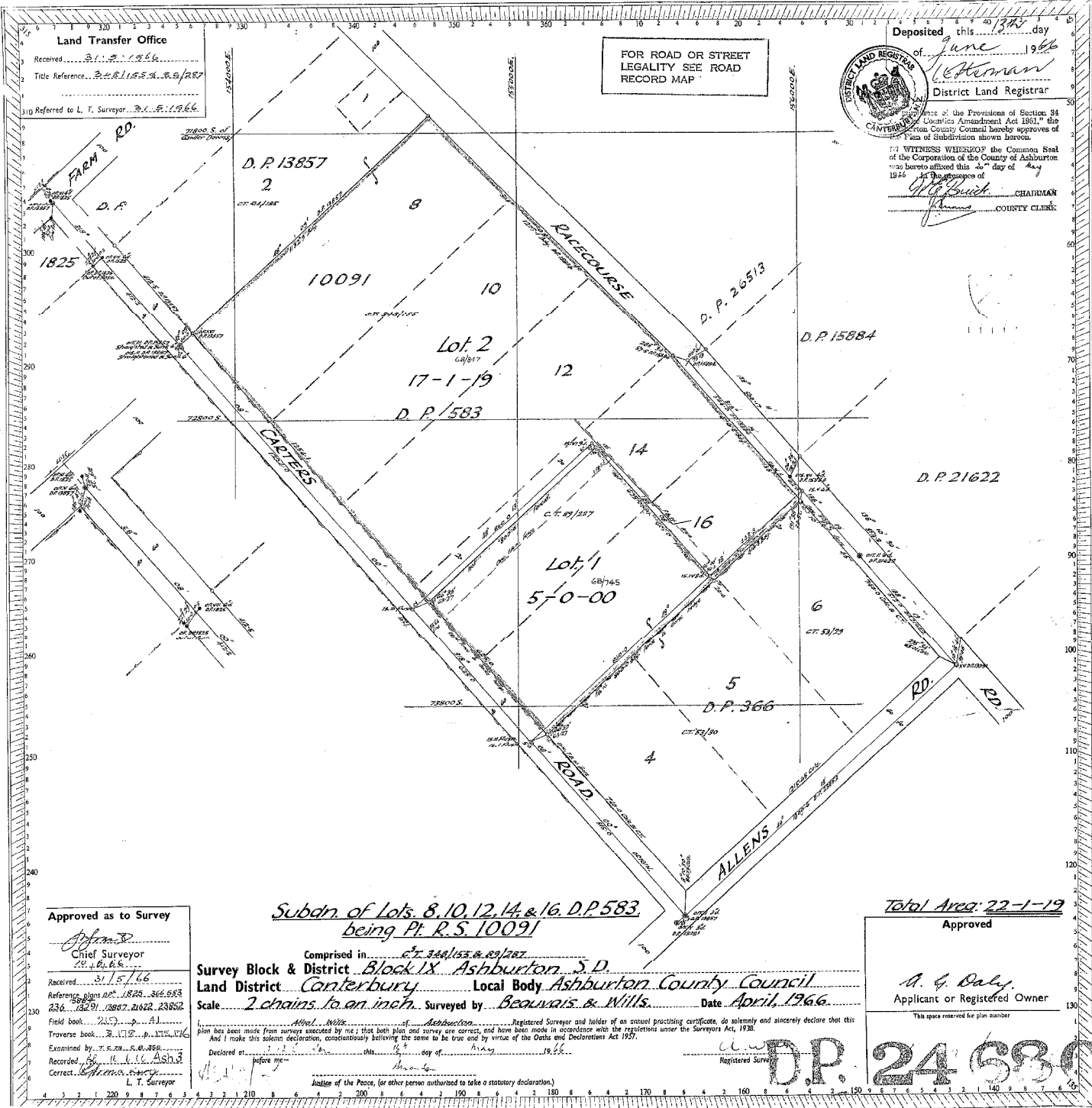

FOR ROAD OR STREET LEGALITY SEE ROAD RECORD MAP

Deposited this 13th day of June 1966
 of [Signature] District Land Registrar



IN WITNESS WHEREOF the Common Seal of the Corporation of the County of Ashburton was hereunto affixed this 13th day of June 1966 in the presence of
 [Signature] CHAIRMAN
 [Signature] COUNTY CLERK

Land Transfer Office
 Received 31.5.1966
 Title Reference 224155A.20/287
 310 Referred to L. T. Surveyor 31.5.1966

Subdn. of Lots 8, 10, 12, 14, & 16, D.P. 583, being Pt. R.S. 10091

Total Area: 22-1-19

Approved as to Survey

[Signature] Chief Surveyor
 Received 31.5.66
 Reference plans 1825, 246, 633, 236, 13857, 21622, 23852
 Field book 215, p. A
 Traverse book 3, 172, p. 115, 116
 Examined by T.S. 28, S.G. 48
 Recorded by L.L. ASD
 Correct [Signature]
 L. T. Surveyor

Comprised in c.T. 224155 & 22422
 Survey Block & District Block IX, Ashburton S.D.
 Land District Canterbury Local Body Ashburton County Council
 Scale 2 chains to an inch. Surveyed by Beauvais & Mills Date April, 1966

Approved
 [Signature] Applicant or Registered Owner
 This space reserved for plan number

Registered Surveyor and holder of an annual practising certificate, do solemnly and sincerely declare that this plan has been made from surveys executed by me; that both plan and survey are correct, and have been made in accordance with the regulations under the Surveyors Act, 1930.
 And I make this solemn declaration, conscientiously believing the same to be true and by virtue of the Oaths and Declarations Act 1957.
 Declared at [Signature] this 13th day of June 1966
 before me [Signature] Registered Surveyor

D.P. 24583

Justice of the Peace, (or other person authorized to take a statutory declaration.)